

# INSTRUMENT & CONTROL SWITCHES

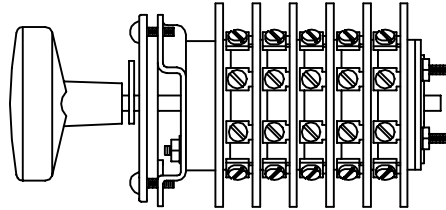

PAGES  
**2 - 11**

## SERIES 95 INSTRUMENT & CONTROL SWITCHES

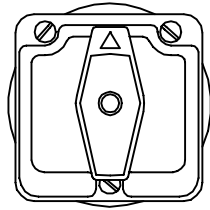
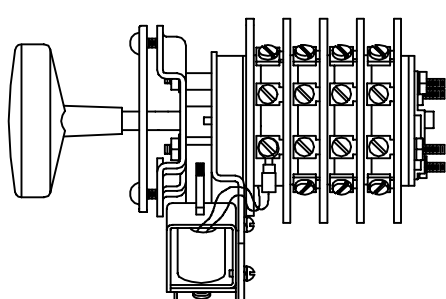
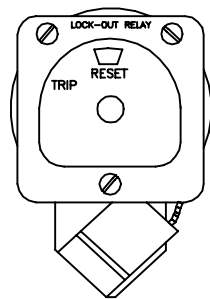

PAGES  
**12 - 20**

## SERIES 95 LOCK-OUT RELAY SWITCHES

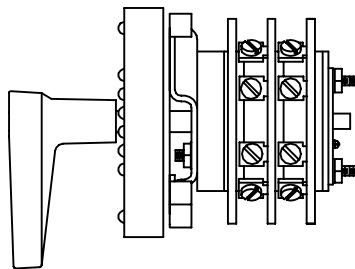
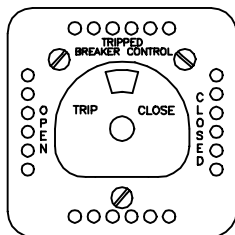

PAGES  
**21 - 22**

## SERIES 95 LIGHTED ESCUTCHEON PLATES

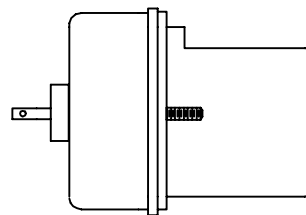
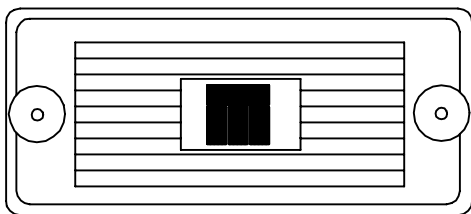

PAGES  
**23 - 25**

## MULTI-CIRCUIT TEST SWITCH TYPE FT



---

THE SERIES 95 INSTRUMENT AND CONTROL SWITCH IS A HEAVY-DUTY ROTARY SWITCH THAT SATISFIES THE MOST DEMANDING REQUIREMENTS OF THE INDUSTRIAL CONTROL AND POWER APPLICATIONS, THESE SWITCHES ARE 600V AC RATED AND ARE RECOGNIZED BY UNDERWRITERS LABORATORIES IN THE UNITED STATES AND CANADA.

SOME OF THE TYPICAL STANDARD APPLICATIONS FOR THE SERIES 95 SWITCHES ARE:

- CIRCUIT-BREAKER CONTROL
- MOTOR CONTROL
- VOLTMETER SELECTOR AND TRANSFER
- AMMETER SELECTOR AND TRANSFER
- VOLT-AMMETER SELECTOR AND TRANSFER
- WATTMETER SELECTOR AND TRANSFER
- SYNCHROSCOPE CONTROL
- CONTROL SELECTOR SWITCH APPLICATIONS

THE SERIES 95 SWITCHES HAVE THE FOLLOWING STANDARD FEATURES:

- STANDARD 3-HOLE MOUNTING
- #8-32 SCREW TERMINALS
- NEMA CLASS A INSULATING MATERIALS (105°C)
- SILVER CONTACT SURFACES FOR LONG RELIABLE LIFE
- DOUBLE-SIDED, DOUBLE-WIPING KNIFE-TYPE ROTARY CONTACTS

SPECIAL FEATURES FOR CONTROL SWITCHES INCLUDES:

- MECHANICAL RED/GREEN TARGET
- SLIP CONTACTS FOR ALARM AND INDICATOR CIRCUITS
- PULL-TO-LOCK MECHANISM FOR A SAFETY LOCK-OUT
- SPRING-RETURN MECHANISM TO RETURN THE SWITCH HANDLE TO THE NORMAL (VERTICAL) POSITION
- SELECTION OF LIGHTED ESCUTCHEON PLATES.

SPECIAL FEATURES FOR METER CONTROL SWITCHES INCLUDES:

- MAKE-BEFORE-BREAK (SHORTING) CONTACTS FOR AMMETER CONTROL (DESIGNED WITH PHYSICALLY OVERLAPPING CONTACTS)
- COMMON-INPUT TAP-SWITCH ARRANGEMENT WHERE BY THE METER MAY BE SEQUENTIALLY CONNECTED TO SEVERAL LINES USING THE SAME SWITCHING DECK
- POSITIVE "SNAPPY" POSITIONING DETENT MECHANISM
- PRE-WIRED JUMPERS

SPECIAL FEATURES FOR SYCHROSCOPE APPLICATIONS INCLUDES:

- REMOVABLE OVAL HANDLES
- KEY LOCKABLE ARRANGEMENTS

THE FOLLOWING DETAILS THE MOST COMMON APPLICATIONS, CONTACT ARRANGEMENTS AND ESCUTCHEON PLATE MARKINGS. FOR COMBINATION OF CONTACT ARRANGEMENTS, HANDLES, ESCUTCHEON PLATE MARKINGS AND SPECIAL FEATURES NOT SHOWN CONTACT FACTORY FOR AVAILABILITY.

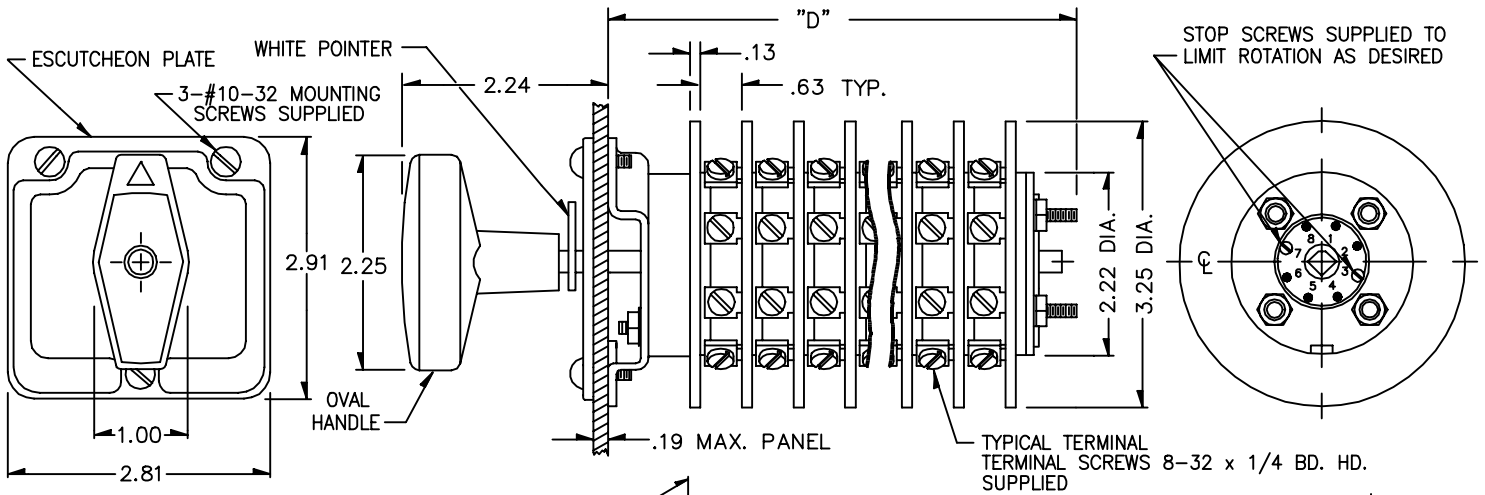
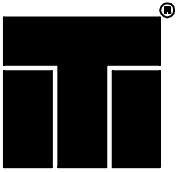

DRILL PATTERN & ESCUTCHEON PLATE DIMENSIONS

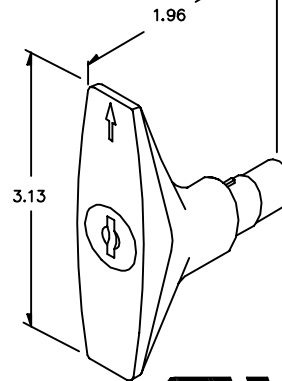
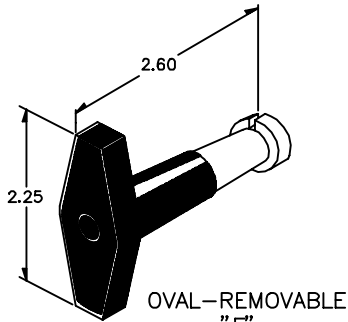
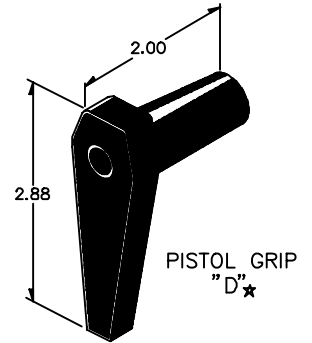
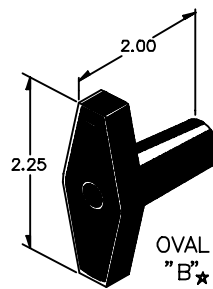
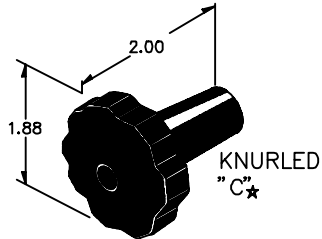
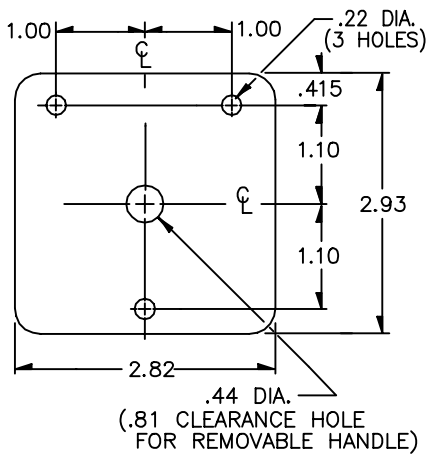

DEPTH BEHIND PANEL	
NUMBER OF DECKS	DEPTH INCHES "D"
1	2.4
2	2.9
3	3.6
4	4.3
5	4.8
6	5.4
7	6.2
8	6.6
9	7.4
10	8.0

Slip Contacts - add 1.5"  
Pull-to-lock - add 1"

(These are approximate dimensions)



INTERRUPTING RATINGS:

UL & CUL GENERAL PURPOSE  
UL FILE NO. E101598

20A-120VAC

15A-240VAC

6A-600VAC

3A-125VDC

1A-250VDC

OPEN CONTINUOUS RATING - 30A-600V  
DIELECTRIC STRENGTH - 2200VRMS

★ LETTER APPEARING AFTER MODEL NO: i.e., 952401C