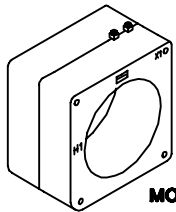
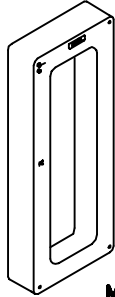
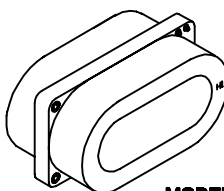
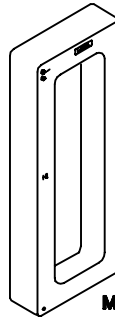
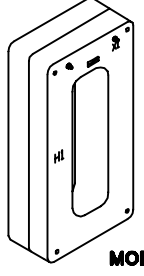
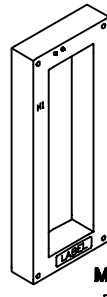

# GROUND FAULT SENSORS ANSI RATED WINDOW TYPE

Window type ground fault sensors are usually used to sense zero sequence ground fault currents. This requires that all three phases and the neutral (in the case of a four wire system) be placed through the window of a single current transformer. Under normal conditions the current transformer will not see any current as the sum of a balanced three phase system is zero thus the name "Zero Sequence".

In as much as all three phases and neutral (if there is one) must pass through the same window. This requires a current transformer with a large window to accommodate all of the conductors.

<p><b>WINDOW DIAMETER</b> 7.31</p>	 <p style="text-align: right;"><b>MODEL</b> 143</p>	<p><b>BODY SIZE</b> W11.10 H11.47 D 6.00 D 8.82 W/BRKT</p> <p style="text-align: right;"><b>PAGE</b> <b>2</b></p>	<p><b>WINDOW SIZE</b> 8.06 X 22.06</p>	 <p style="text-align: right;"><b>MODEL</b> 593</p>	<p><b>BODY SIZE</b> W13.58 H27.56 D 5.50</p> <p style="text-align: right;"><b>PAGE</b> <b>5</b></p>
<p><b>WINDOW SIZE</b> 4.28 X 11.28</p>	 <p style="text-align: right;"><b>MODEL</b> 590</p>	<p><b>BODY SIZE</b> W14.52 H 7.48 D 7.35</p> <p style="text-align: right;"><b>PAGE</b> <b>3</b></p>	<p><b>WINDOW SIZE</b> 8.06 X 20.06</p>	 <p style="text-align: right;"><b>MODEL</b> 594</p>	<p><b>BODY SIZE</b> W13.58 H25.56 D 5.50</p> <p style="text-align: right;"><b>PAGE</b> <b>6</b></p>
<p><b>WINDOW SIZE</b> 5.00 X 14.00</p>	 <p style="text-align: right;"><b>MODEL</b> 592</p>	<p><b>BODY SIZE</b> W14.00 H23.00 D 4.00</p> <p style="text-align: right;"><b>PAGE</b> <b>4</b></p>	<p><b>WINDOW SIZES</b> 4.56 X 13.44  4.56 X 17.63</p>	 <p style="text-align: right;"><b>MODEL</b> 595 596</p>	<p><b>BODY SIZE</b> W 8.50 H17.50 D 2.00  W 8.50 H21.63 D 2.13</p> <p style="text-align: right;"><b>PAGE</b> <b>7</b></p>

# CURRENT TRANSFORMER

Model 143

Window Diameter 7.31"

**APPLICATION:**  
Relaying and metering.

**FREQUENCY:**  
50–400 Hz.

**INSULATION LEVEL:**  
600 Volts, 10 kV BIL full wave.

- Terminals are brass screws No.10–32 with one flatwasher and lockwasher.
- Order mounting bracket kit 0221B00775 separately.
- Multi-ratios available on request.
- Approximate weight 60 lbs.

REGULATORY AGENCY APPROVALS



Manufactured to meet the requirements of ANSI/IEEE C57.13.  
Classified by U.L. in accordance with IEC 44-1  
Approved for revenue metering by Industry Canada. No. AE-0642(\*)

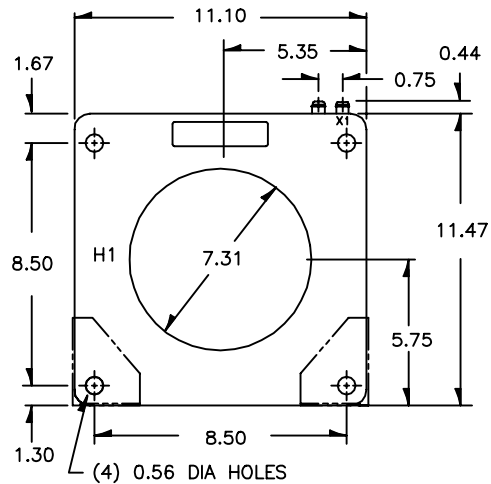
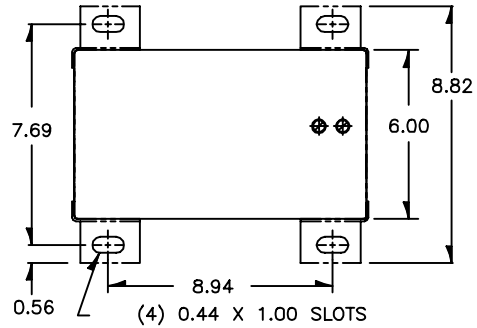
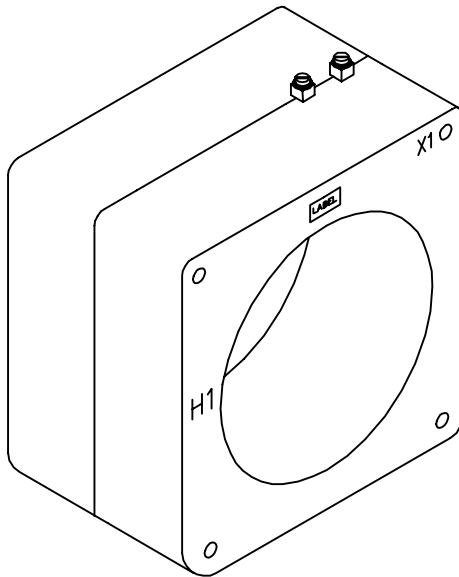

EXCITATION CURVE

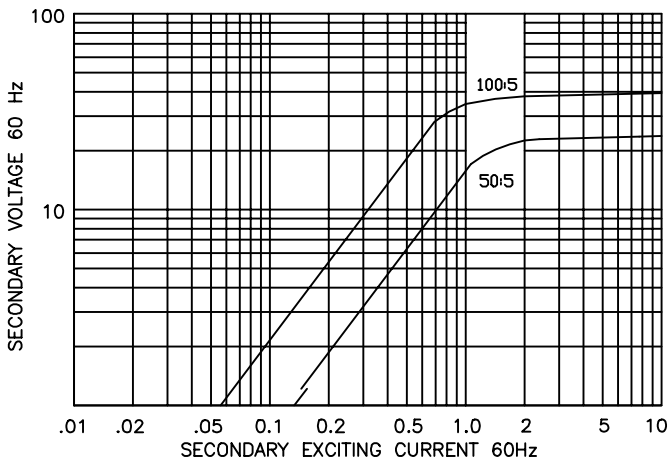

CATALOG NUMBER	CURRENT RATIO	RELAY CLASS	SECONDARY WINDING RESISTANCE (OHMS @ 75 °C)	CONTINUOUS THERMAL RATING FACTOR	
				@30°C	@55°C
143-500	50:5	C20	0.014	2.0	2.0
143-101	100:5	C20	0.056	2.0	2.0

# CURRENT TRANSFORMER

Model 590

Window 4.28" X 11.28"

**APPLICATION:**  
Relaying.

**FREQUENCY:**  
50-400 Hz.

**INSULATION LEVEL:**  
600 Volts, 10 kV BIL full wave.

- Terminals are No.10 brass screws with one flatwasher and lockwasher, accessible from both sides.
- Approximate weight: 70 lbs.

REGULATORY AGENCY APPROVALS



Manufactured to meet the requirements of ANSI/IEEE C57.13.  
Classified by U.L. in accordance with IEC 44-1

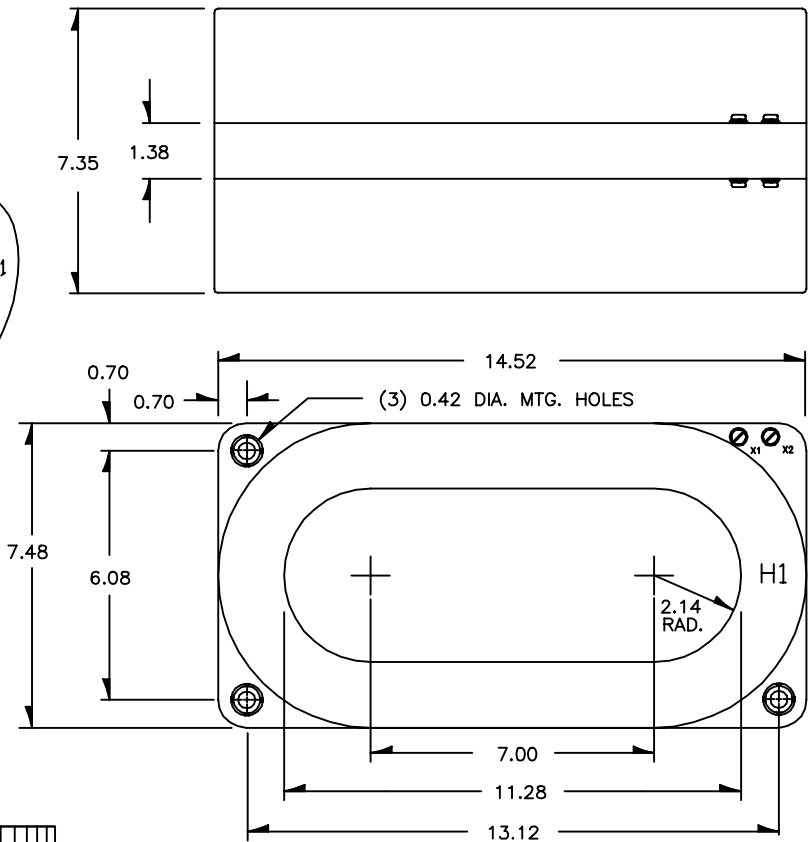
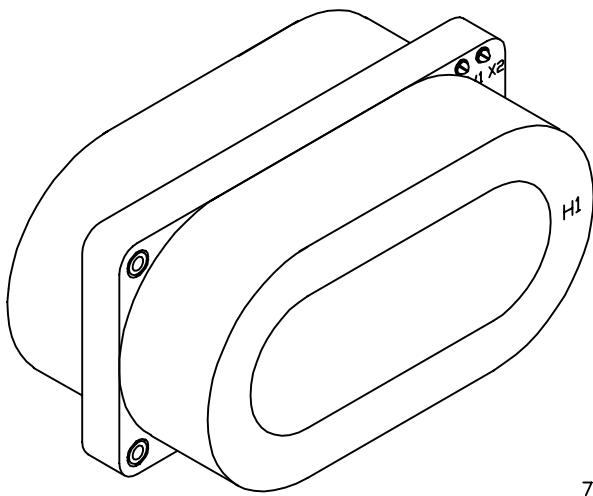

EXCITATION CURVE

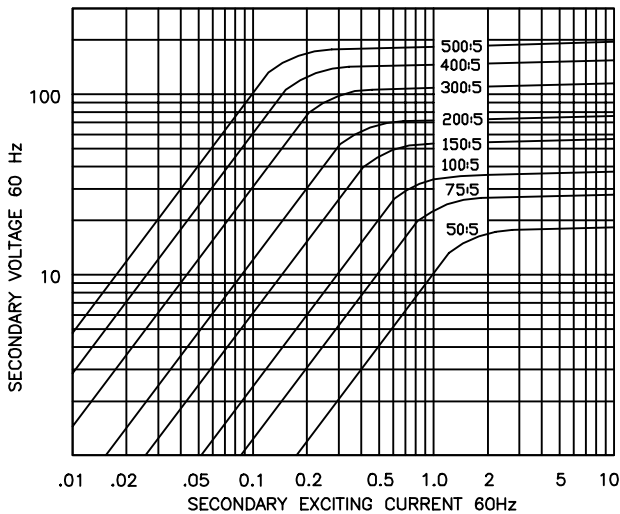

CATALOG NUMBER	CURRENT RATIO	RELAY CLASS	SECONDARY WINDING RESISTANCE (OHMS @ 75 °C)	CONTINUOUS THERMAL RATING FACTOR	
				@30°C	@55°C
590-500	50:5	C15	0.016	2.0	2.0
590-750	75:5	C25	0.024	2.0	2.0
590-101	100:5	C35	0.063	2.0	2.0
590-151	150:5	C50	0.095	2.0	2.0
590-201	200:5	C70	0.127	2.0	2.0
590-301	300:5	C100	0.190	2.0	2.0
590-401	400:5	C150	0.254	2.0	2.0
590-501	500:5	C180	0.317	2.0	2.0

# CURRENT TRANSFORMER

**Model 592**

*Window Size 5.00" X 14.00"*

**CAST RESIN CONSTRUCTION**

**APPLICATION:**

Relaying and metering.

**FREQUENCY:**

50-400 Hz.

**INSULATION LEVEL:**

600 Volts, 10 kV BIL full wave.

**CONTINUOUS THERMAL**

**CURRENT RATING FACTOR:**

2.0 at 30°C. amb.

1.5 at 55°C. amb.

- Terminals are brass studs No. 10-32 with one flatwasher, lockwasher and regular nut.

- Approximate weight 150 lbs.

REGULATORY AGENCY APPROVALS



Manufactured to meet the requirements of ANSI/IEEE C57.13.  
Classified by U.L. in accordance with IEC 44-1

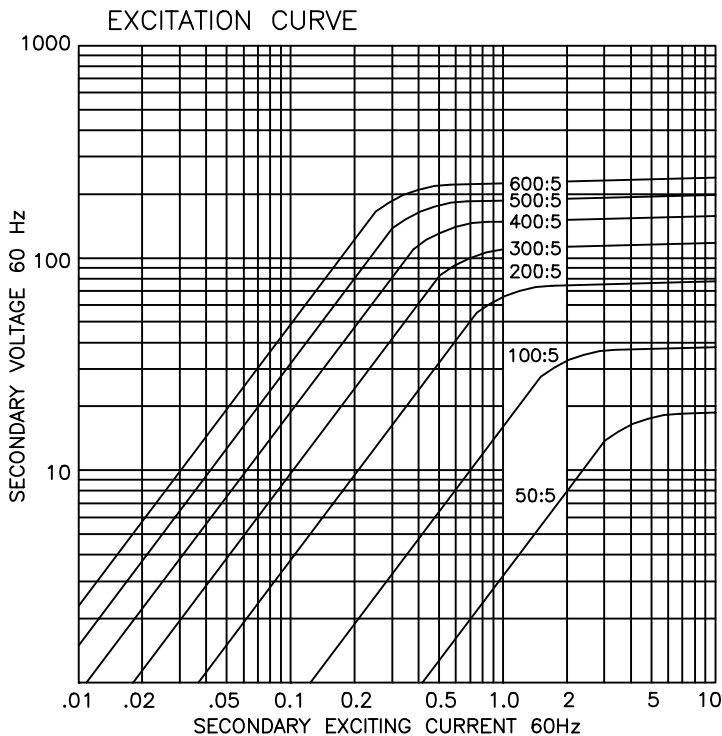
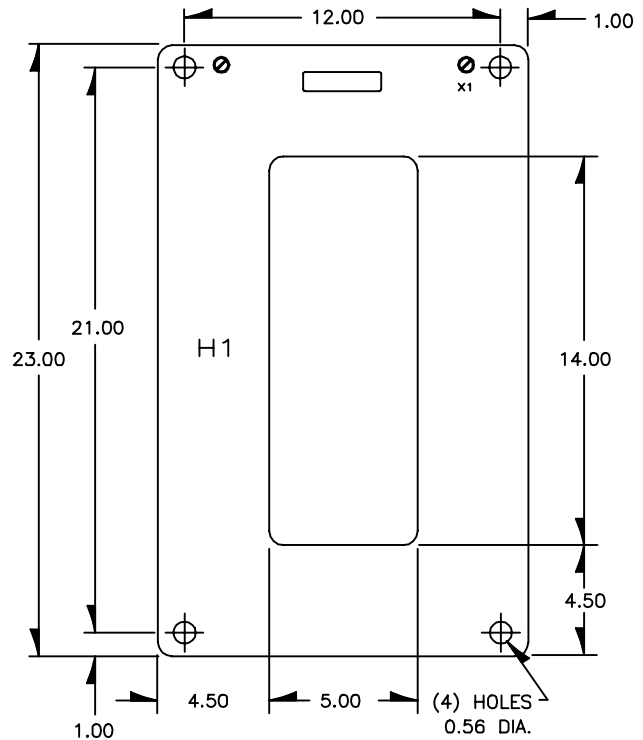
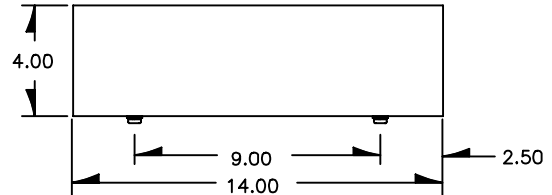
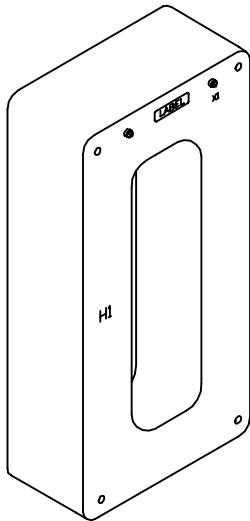

CATALOG NUMBER	CURRENT RATIO	RELAY CLASS	SECONDARY WINDING RESISTANCE (OHMS @ 75°C.)
592-500	50:5	C15	0.014
592-101	100:5	C30	0.028
592-201	200:5	C60	0.056
592-301	300:5	C100	0.097
592-401	400:5	C120	0.123
592-501	500:5	C150	0.161
592-601	600:5	C200	0.193

# CURRENT TRANSFORMER

**Model 593**

*Window Size 8.06" X 22.06"*

**Cast Resin Construction**

**APPLICATION:**

Relaying

**FREQUENCY:**

50-400 Hz.

**INSULATION LEVEL:**

600 Volts, 10 kV BIL full wave.

**CONTINUOUS THERMAL CURRENT RATING FACTOR:**

2.00 at 30°C. amb.

2.00 at 55°C. amb.

- Terminals are brass studs No. 10-32 with one flatwasher, lockwasher and regular nut.
- Approximate weight 150 lbs.

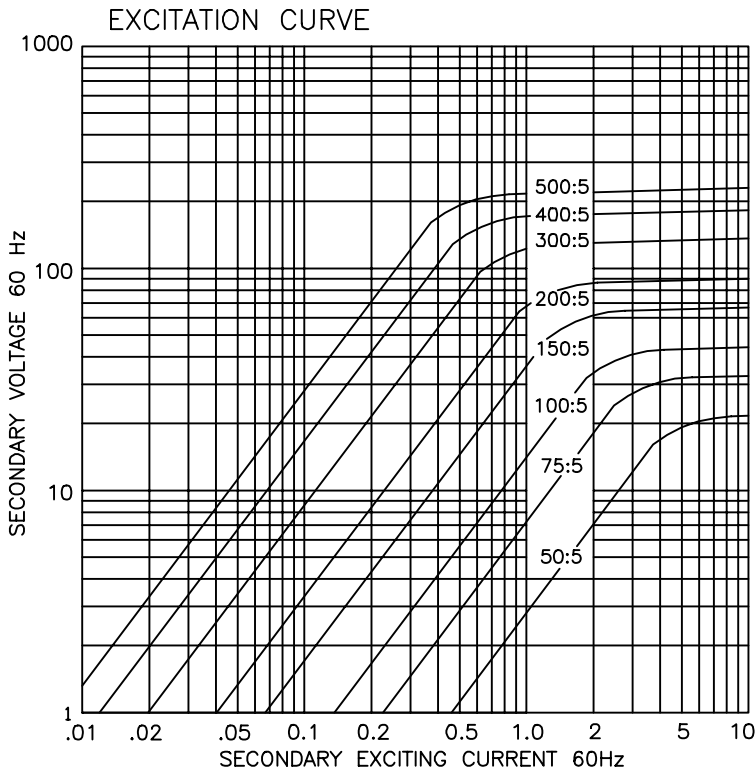
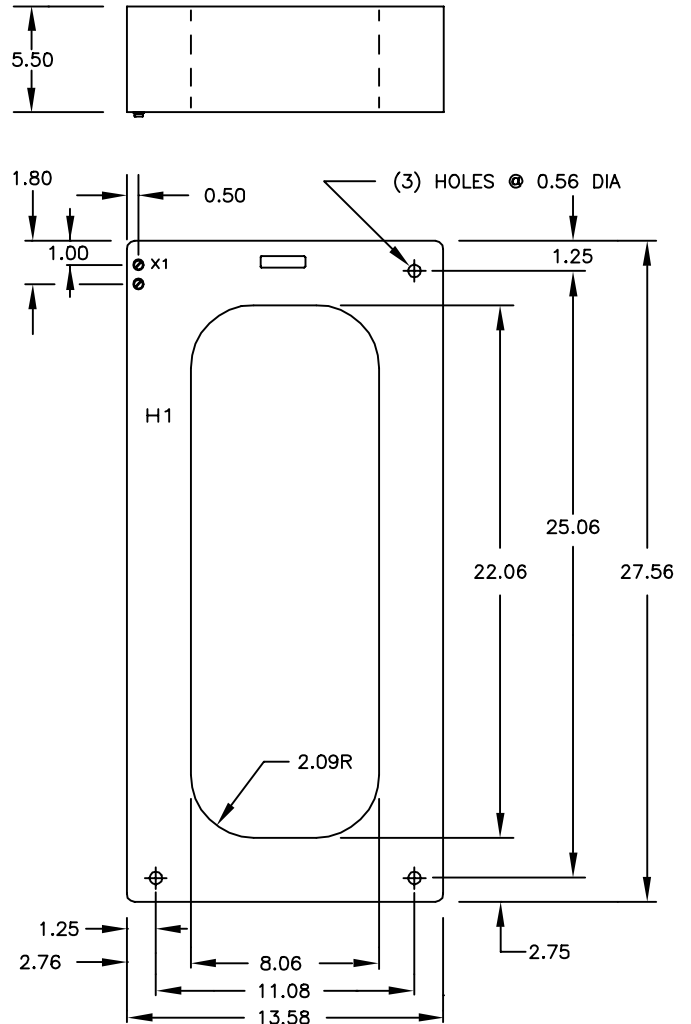
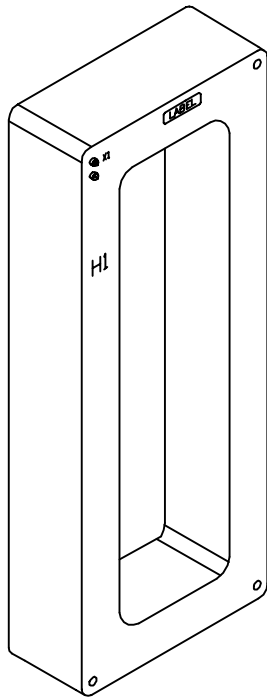

CATALOG NUMBER	CURRENT RATIO	RELAY CLASS	SECONDARY WINDING RESISTANCE (OHMS @ 75°C.)
593-500	50:5	C10	0.013
593-750	75:5	C20	0.020
593-101	100:5	C30	0.027
593-151	150:5	C50	0.040
593-201	200:5	C50	0.054
593-301	300:5	C100	0.081
593-401	400:5	C100	0.108
593-501	500:5	C200	0.134

# CURRENT TRANSFORMER

**Model 594**

*Window Size 8.06" X 20.06"*

**Cast Resin Construction**

**APPLICATION:**

Relaying

**FREQUENCY:**

50-400 Hz.

**INSULATION LEVEL:**

600 Volt, 10 kV BIL full wave.

**CONTINUOUS THERMAL CURRENT RATING FACTOR:**

2.00 at 30°C. amb.

2.00 at 55°C. amb.

- Terminals are brass studs No. 10-32 with one flatwasher, lockwasher and regular nut.

- Approximate weight 150 lbs.

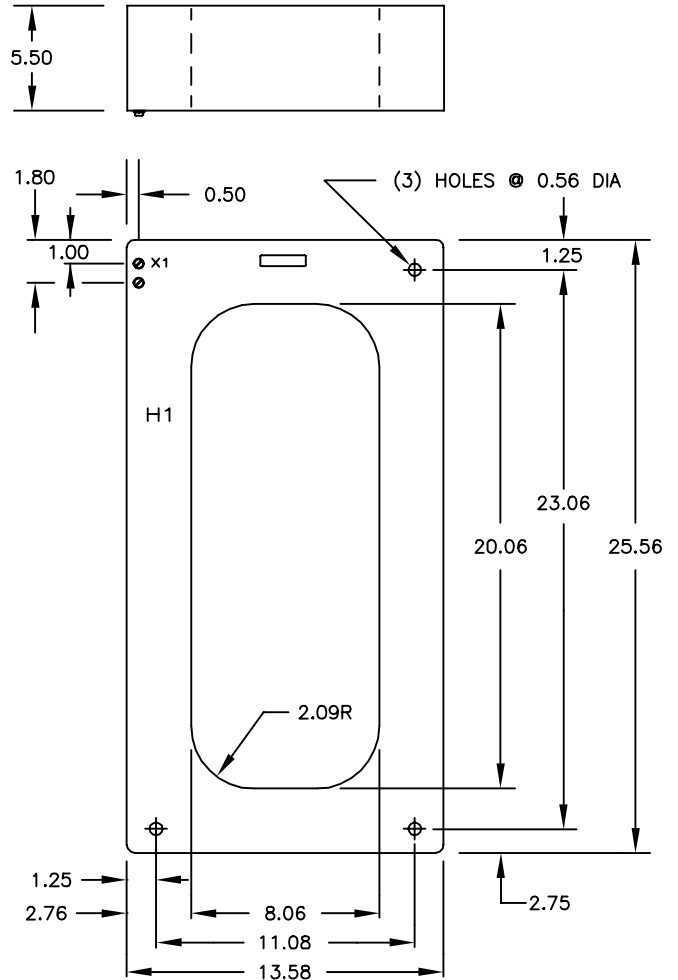
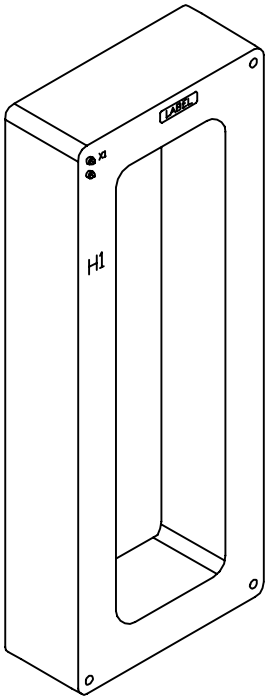

EXCITATION CURVE

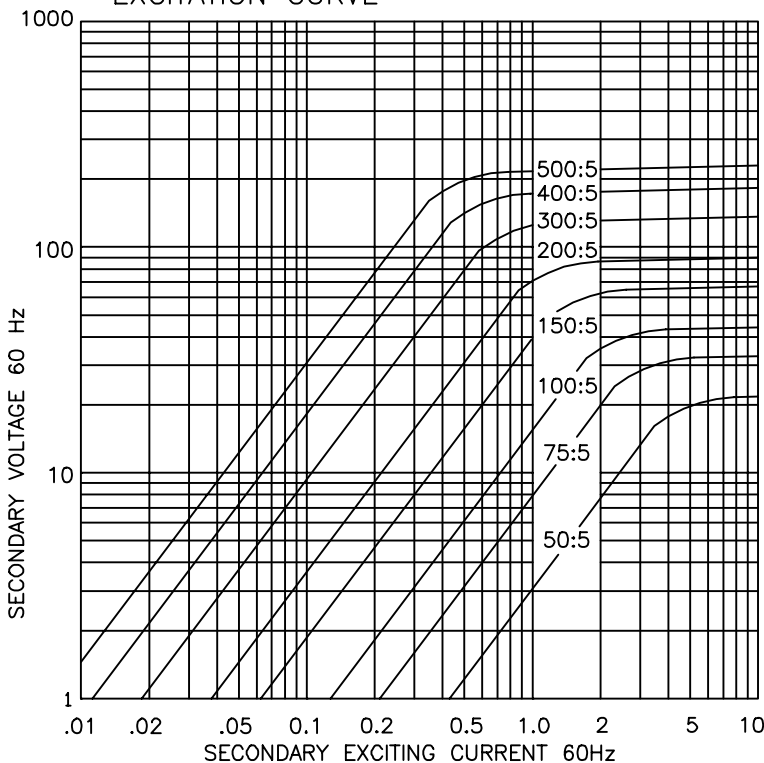

CATALOG NUMBER	CURRENT RATIO	RELAY CLASS	SECONDARY WINDING RESISTANCE (OHMS @ 75°C.)
594-500	50:5	C10	0.013
594-750	75:5	C20	0.020
594-101	100:5	C30	0.027
594-151	150:5	C50	0.040
594-201	200:5	C50	0.054
594-301	300:5	C100	0.081
594-401	400:5	C100	0.108
594-501	500:5	C200	0.134

# ZERO-SEQUENCE CURRENT TRANSFORMER

**Model 595, 596**

*Window Sizes 4.56" X 13.44"  
4.56" X 17.63"*

**Cast Resin Construction**

**APPLICATION:**

Zero - Sequence

**FREQUENCY:**

50-400 Hz.

**INSULATION LEVEL:**

600 Volts, 10 kV BIL full wave.

**CONTINUOUS THERMAL**

**CURRENT RATING FACTOR:**

2.00 at 30°C. amb.

2.00 at 55°C. amb.

- Terminals are brass screws No. 8-32 with lockwashers.
- Finish: Cast resin red.
- 4 holes mounting system also available with brackets consult factory for details.
- Approximate weight: 24-29 lbs.

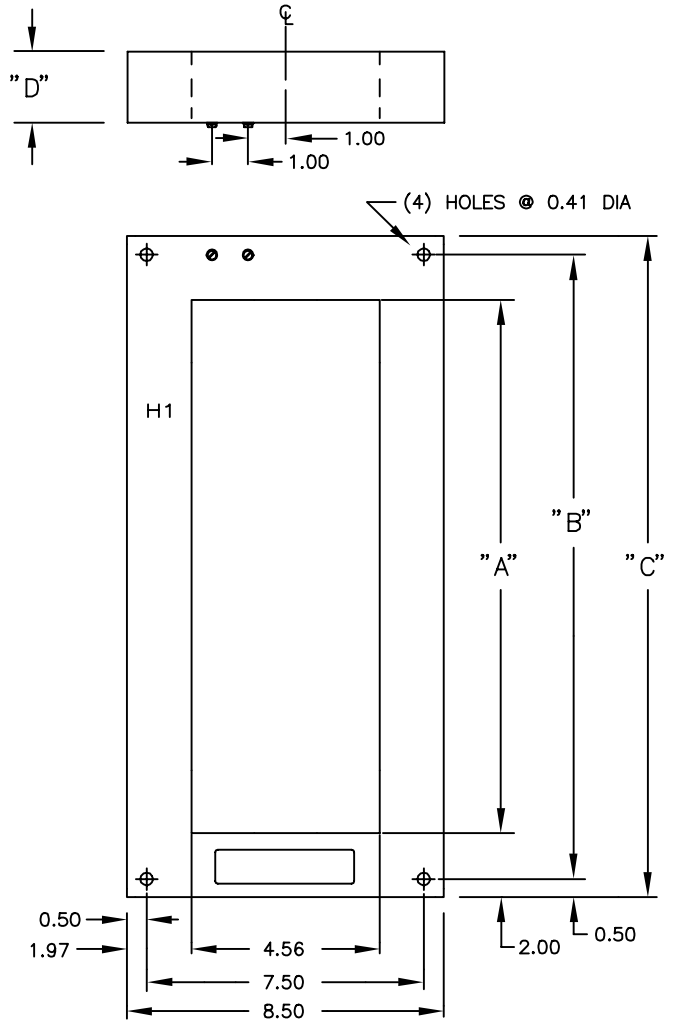
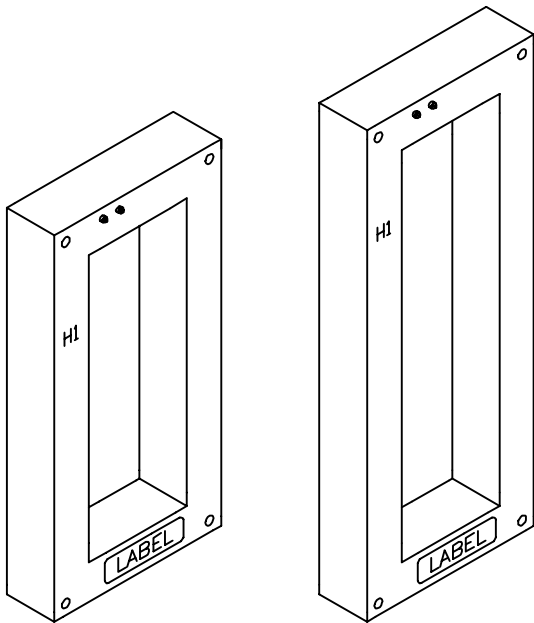

DIMENSIONS

MODEL	"A"	"B"	"C"	"D"
595	13.44	16.50	17.50	2.00
596	17.63	20.63	21.63	2.13

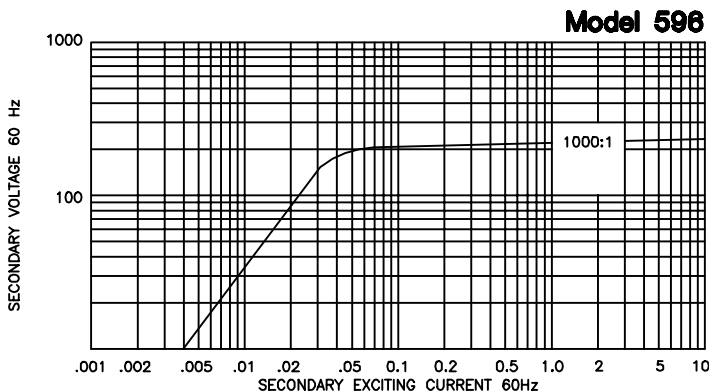
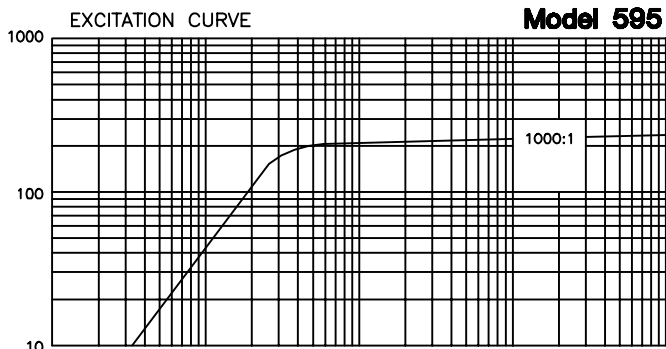

CATALOG NUMBER	CURRENT RATIO	SECONDARY WINDING RESISTANCE (OHMS @ 75°C.)
595-102-1	1000:1	7.52
596-102-1	1000:1	7.52