

CURRENT TRANSFORMER

Model 787

Window Diameter 6.69"

APPLICATION:
Relaying and metering.

FREQUENCY:
50-400 Hz.

INSULATION LEVEL:
0.6 kV, BIL 10 kV full wave.

CONTINUOUS THERMAL CURRENT RATING FACTOR:
1.33 at 30°C. amb., 1.0 at 55°C. amb.

- Secondary terminals are brass screws No. 1/4-20 with one flatwasher and lockwasher.
- The core and coil are cast in polyurethane resin.
- Multi-ratios available on request.
- Approximate weight 72 lbs.

REGULATORY AGENCY APPROVALS



Manufactured to meet the requirements of ANSI/IEEE C57.13.
Classified by U.L. in accordance with IEC 44-1.

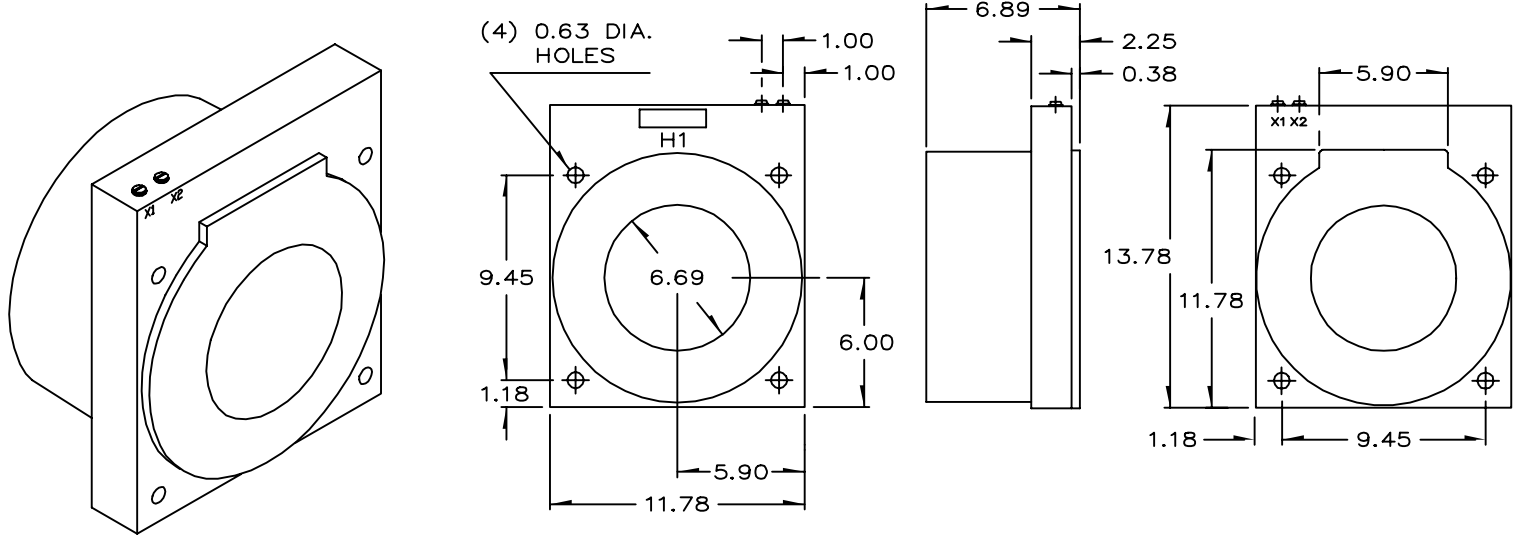

EXCITATION CURVE

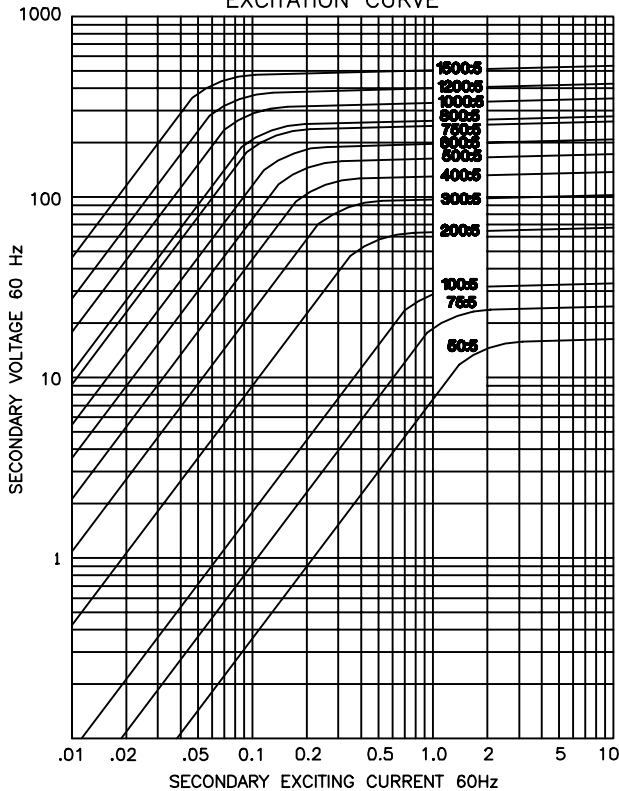

CATALOG NUMBER	CURRENT RATIO	RELAY CLASS	ANSI METERING CLASS AT 60 Hz					SECONDARY WINDING RESISTANCE (OHMS @ 75 °C)
			B0.1	B0.2	B0.5	B0.9	B1.8	
787-500	50:5	C20	4.8	4.8	-	-	-	0.017
787-750	75:5	C20	1.2	2.4	4.8	-	-	0.025
787-101	100:5	C20	0.6	1.2	4.8	4.8	-	0.033
787-201	200:5	C50	0.3	0.6	1.2	1.2	2.4	0.067
787-301	300:5	C100	0.3	0.3	0.6	1.2	1.2	0.100
787-401	400:5	C200	0.3	0.3	0.3	0.6	1.2	0.120
787-501	500:5	C200	0.3	0.3	0.3	0.3	0.6	0.300
787-601	600:5	C200	0.3	0.3	0.3	0.3	0.6	0.360
787-751	750:5	C200	0.3	0.3	0.3	0.3	0.3	0.450
787-801	800:5	C200	0.3	0.3	0.3	0.3	0.3	0.480
787-102	1000:5	C400	0.3	0.3	0.3	0.3	0.3	0.600
787-122	1200:5	C400	0.3	0.3	0.3	0.3	0.3	0.720
787-152	1500:5	C400	0.3	0.3	0.3	0.3	0.3	0.900