

CURRENT TRANSFORMER

Model 730

Window Diameters

5.56", 6.56"

APPLICATION:
Relaying and metering.

FREQUENCY:
50-400 Hz.

INSULATION LEVEL:
0.6 kV, BIL 10 kV full wave.

REGULATORY AGENCY APPROVALS



Manufactured to meet the requirements of ANSI/IEEE C57.13.
Classified by U.L. in accordance with IEC 44-1.

Approved for revenue metering by Industry Canada. T-210(+)

CONTINUOUS THERMAL CURRENT RATING FACTOR:

1.33 at 30°C. amb., 1.0 at 55°C. amb.

- Secondary terminals are brass screws No.10-32 with one flat-washer, lockwasher and regular nut.
- Model 731 (multi-ratios) available on request.
- Approximate weight:
50:5 thru 600:5 - 61 lbs.
750:5 thru 2500:5 - 32 lbs.

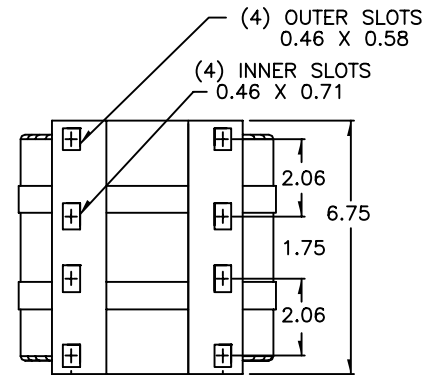
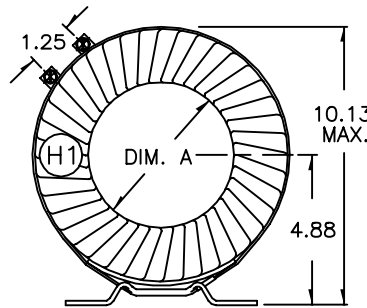
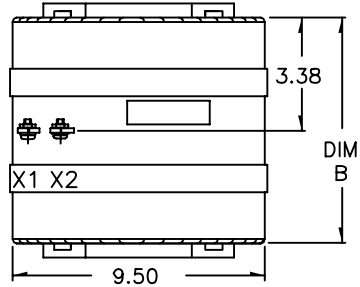
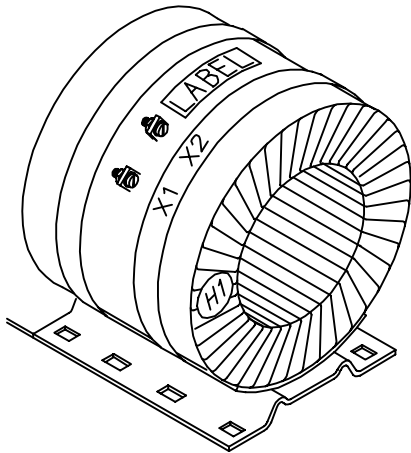

BASEPLATE (BOTTOM VIEW)

EXCITATION CURVE

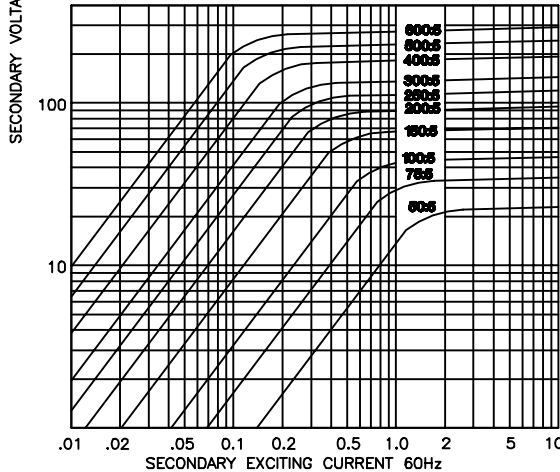
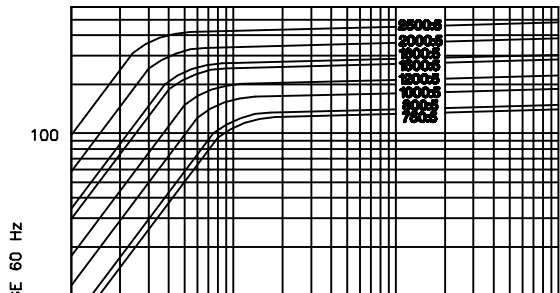
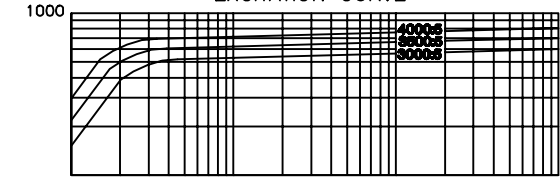

CATALOG NUMBER	CURRENT RATIO	RELAY CLASS	ANSI METERING CLASS AT 60 Hz					SECONDARY WINDING RESISTANCE (OHMS @ 75°C)	DIM A.	DIM B.
			B0.1	B0.2	B0.5	B0.9	B1.8			
730-500	50:5	C20	2.4	-	-	-	-	0.023	5.56 MIN.	6.75 MAX.
730-750	75:5	C20	1.2	2.4	-	-	-	0.035		
730-101	100:5	C20	0.6	1.2	2.4	-	-	0.047		
730-151	150:5	C50	0.6	0.6	1.2	2.4	-	0.072		
730-201	200:5 *	C50	0.3	0.6	0.6	1.2	2.4	0.096		
730-251	250:5 *	C100	0.3	0.3	0.6	0.6	1.2	0.120		
730-301	300:5 *	C100	0.3	0.3	0.3	0.6	1.2	0.144		
730-401	400:5 *	C200	0.3	0.3	0.3	0.3	0.6	0.192		
730-501	500:5 *	C200	0.3	0.3	0.3	0.3	0.3	0.240		
730-601	600:5 *	C200	0.3	0.3	0.3	0.3	0.3	0.289		
730-751	750:5	C100	0.3	0.3	0.3	0.3	0.3	0.248		
730-801	800:5 *	C100	0.3	0.3	0.3	0.3	0.3	0.264		
730-102	1000:5 *	C100	0.3	0.3	0.3	0.3	0.3	0.330		
730-122	1200:5 *	C200	0.3	0.3	0.3	0.3	0.3	0.396		
730-152	1500:5 *	C200	0.3	0.3	0.3	0.3	0.3	0.514		
730-162	1600:5	C200	0.3	0.3	0.3	0.3	0.3	0.548		
730-202	2000:5 *	C200	0.3	0.3	0.3	0.3	0.3	0.685		
730-252	2500:5 *	C200	0.3	0.3	0.3	0.3	0.3	0.856		
730-302	3000:5 *	C200	0.3	0.3	0.3	0.3	0.3	1.273		
730-352	3500:5 *	C200	0.3	0.3	0.3	0.3	0.3	1.860		
730-402	4000:5 *	C200	0.3	0.3	0.3	0.3	0.3	2.126		
									6.56 MIN.	5.00 MAX.
										6.25 MAX.