

# CURRENT TRANSFORMER

Model 711

Window Diameter 7.00"

**APPLICATION:**  
Relaying and metering.

**FREQUENCY:**  
50-400 Hz.

**INSULATION LEVEL:**  
0.6 kV, BIL 10 kV full wave.  
REGULATORY AGENCY APPROVALS



Manufactured to meet the requirements of ANSI/IEEE C57.13.  
Classified by U.L. in accordance with IEC 44-1.

**CONTINUOUS THERMAL CURRENT RATING FACTOR:**  
2.0 at 30°C amb., 1.5 at 55°C amb.

- Secondary terminals are brass screws No.10-32 with one flat-washer, lockwasher and regular nut.
- Approximate weight 35 lbs.

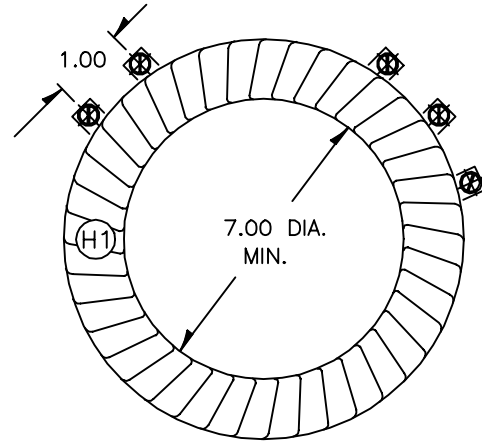
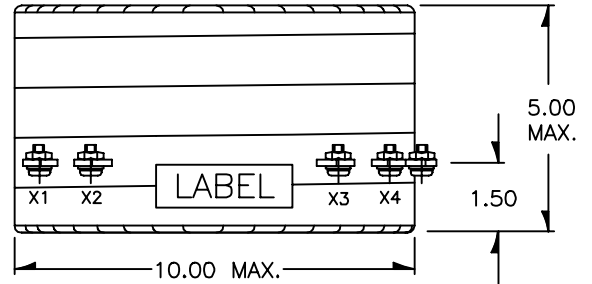
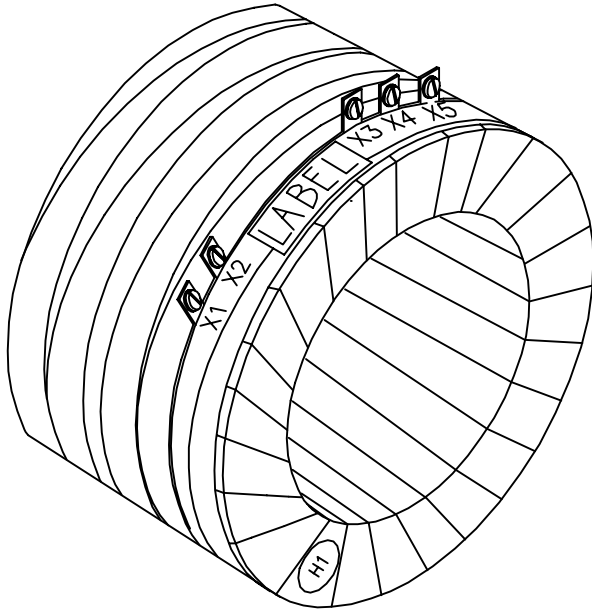

EXCITATION CURVE

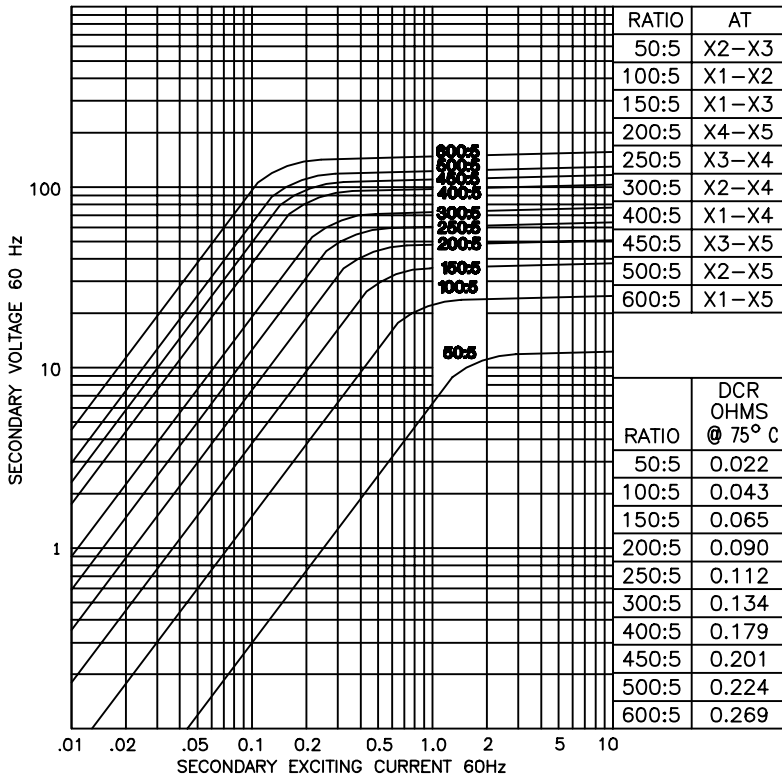

CONNECTION DIAGRAM

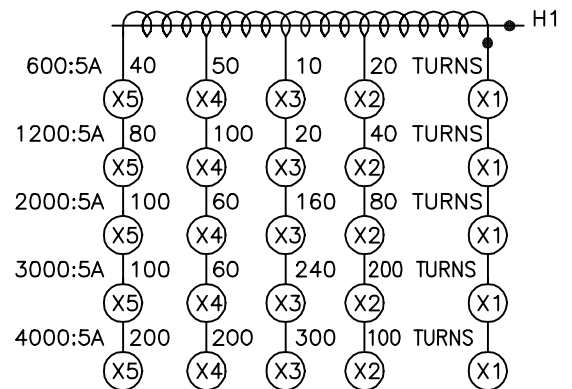

MODEL 711 - 601MR - rating C130

# TYPICAL EXCITATION CURVES - MODEL 711

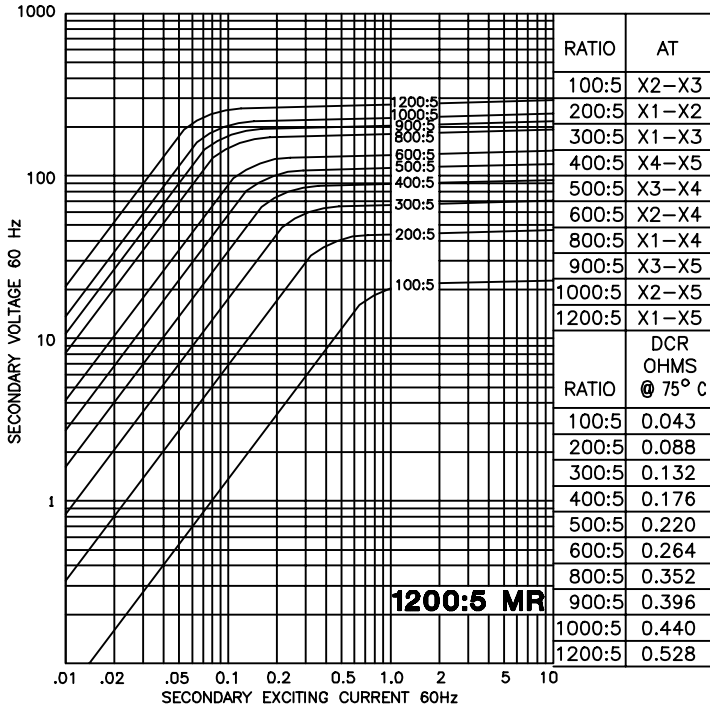

**MODEL 711 - 122MR - rating C250**

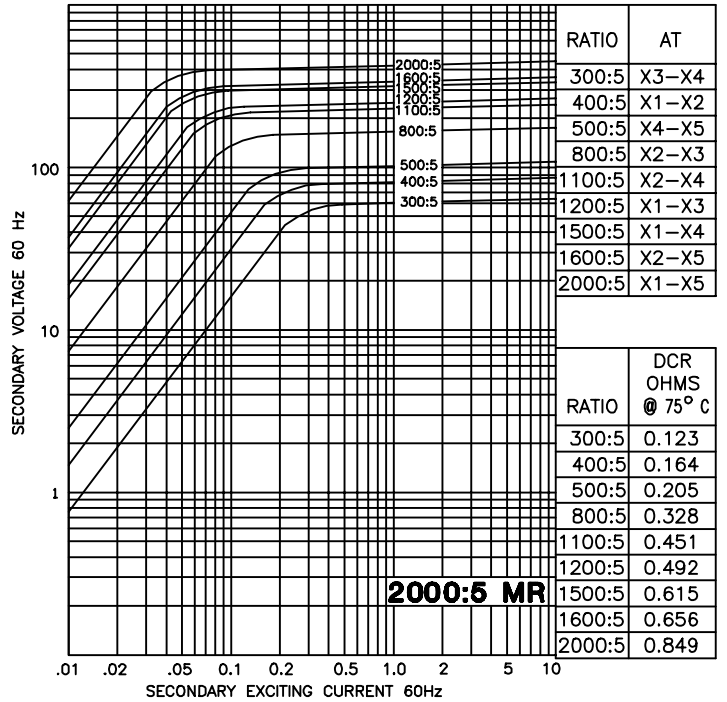

**MODEL 711 - 202MR - rating C380**

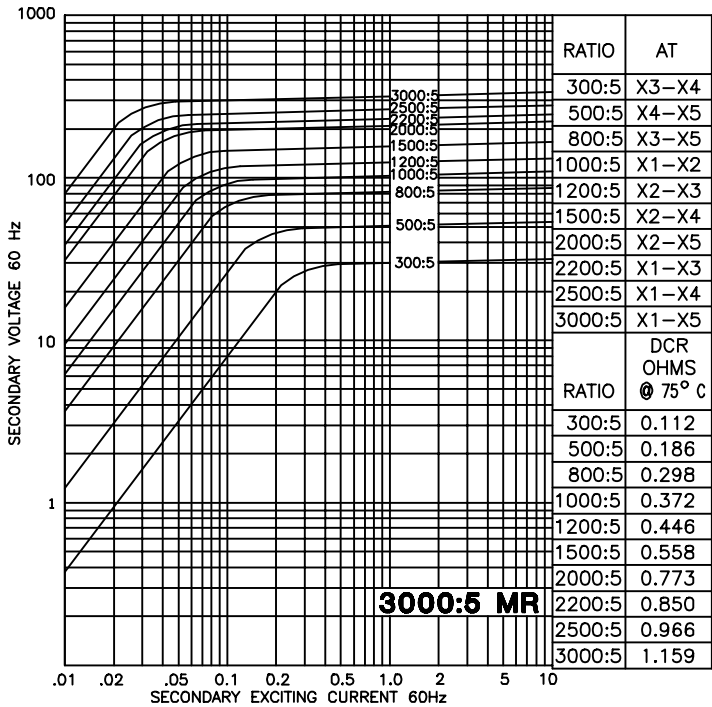

**MODEL 711 - 302MR - rating C260**

