

# CURRENT TRANSFORMER

Model 701

Window Diameter 4.50"

**APPLICATION:**  
Relaying and metering.

**FREQUENCY:**  
50-400 Hz.

**INSULATION LEVEL:**  
0.6 kV. BIL 10 kV. full wave.

REGULATORY AGENCY APPROVALS



Manufactured to meet the requirements of ANSI/IEEE C57.13.  
Classified by U.L. in accordance with IEC 44-1.

**CONTINUOUS THERMAL CURRENT RATING FACTOR:**  
2.0 at 30°C amb., 1.5 at 55°C amb.

- Secondary terminals are brass screws No.10-32 with one flat-washer, lockwasher and regular nut.
- Approximate weight 12 lbs.

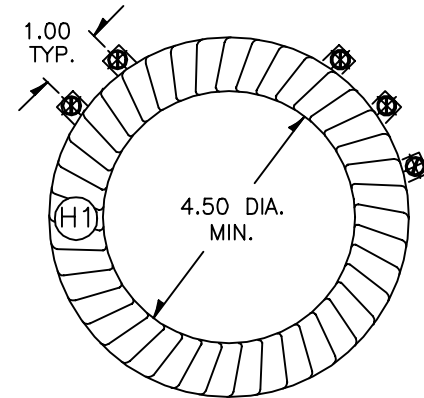
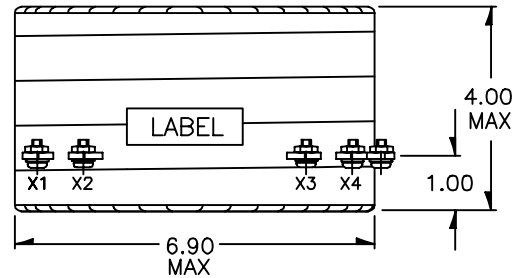
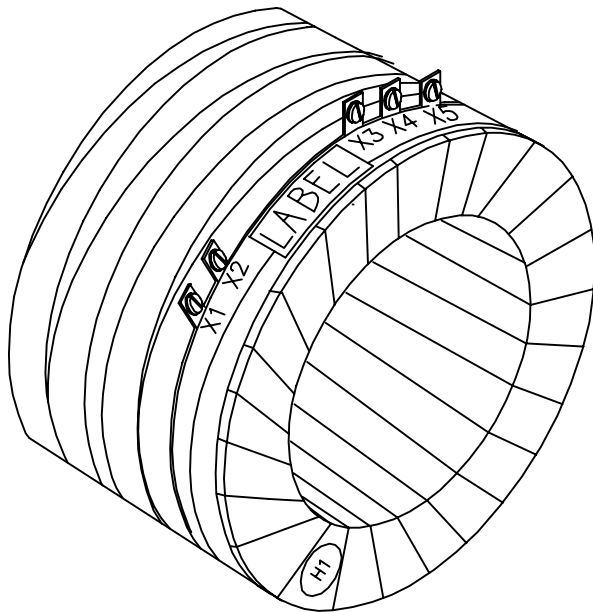

EXCITATION CURVE

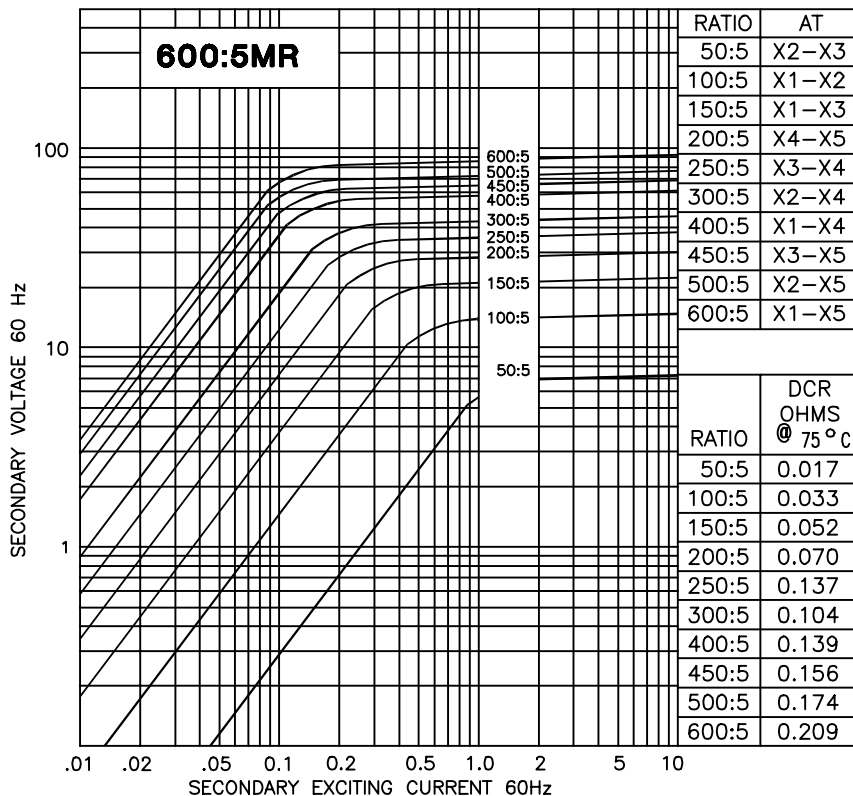

MODEL 701 - 601MR - rating C70

CONNECTION DIAGRAM

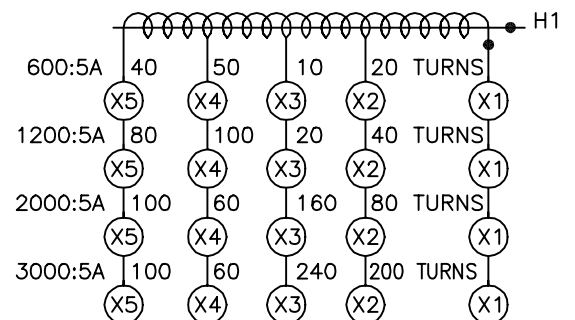

# TYPICAL EXCITATION CURVES - MODEL 701

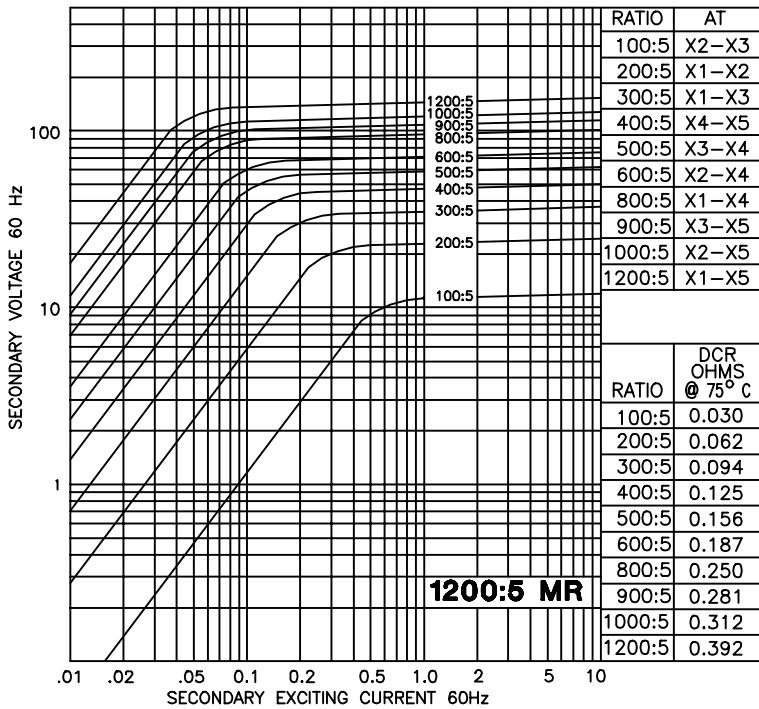

**MODEL 701 - 122MR - rating C110**

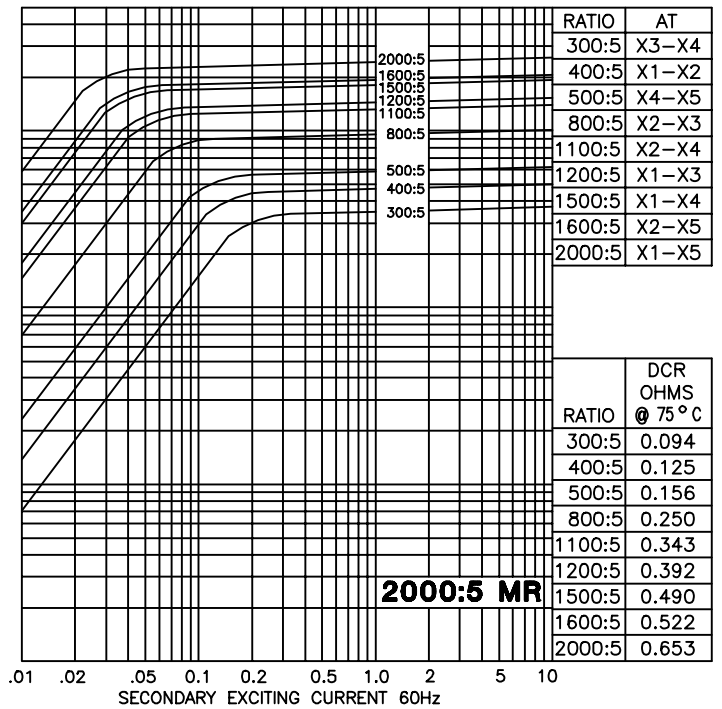

**MODEL 701 - 202MR - rating C120**

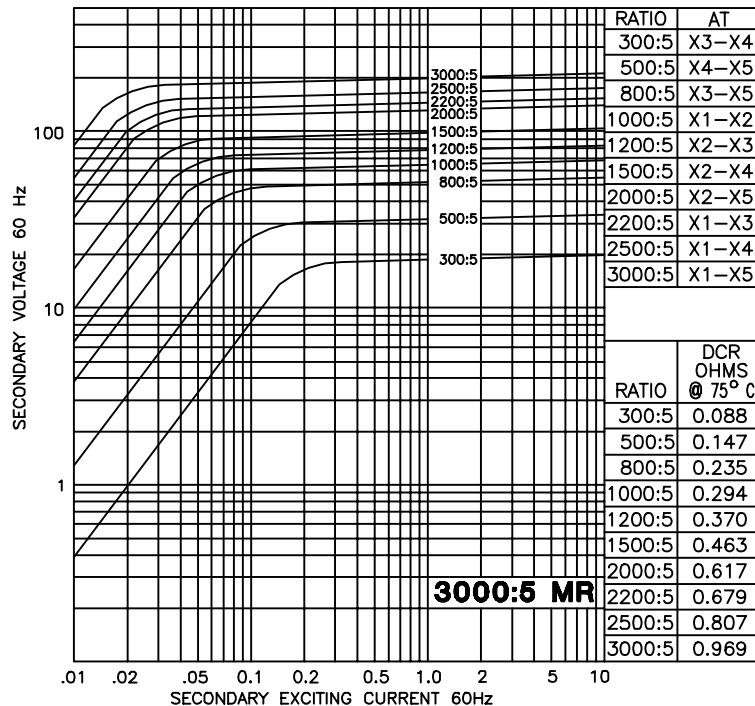

**MODEL 701 - 302MR - C100**