

# CURRENT TRANSFORMER

Model 660

Window Diameter 4.00"

**APPLICATION:**  
Metering.

**FREQUENCY:**  
50-400 Hz.

**INSULATION LEVEL:**  
0.6 kV, BIL 10 kV full wave.  
REGULATORY AGENCY APPROVALS



Manufactured to meet the requirements of ANSI/IEEE C57.13.  
Classified by U.L. in accordance with IEC 44-1.

**CONTINUOUS THERMAL CURRENT RATING FACTOR:**  
1.33 at 30°C. amb., 1.0 at 55°C. amb.

- Secondary terminals are No. 8-32 brass studs with one flatwasher, lockwasher and regular nut.
- Approximate weight 2 lbs.

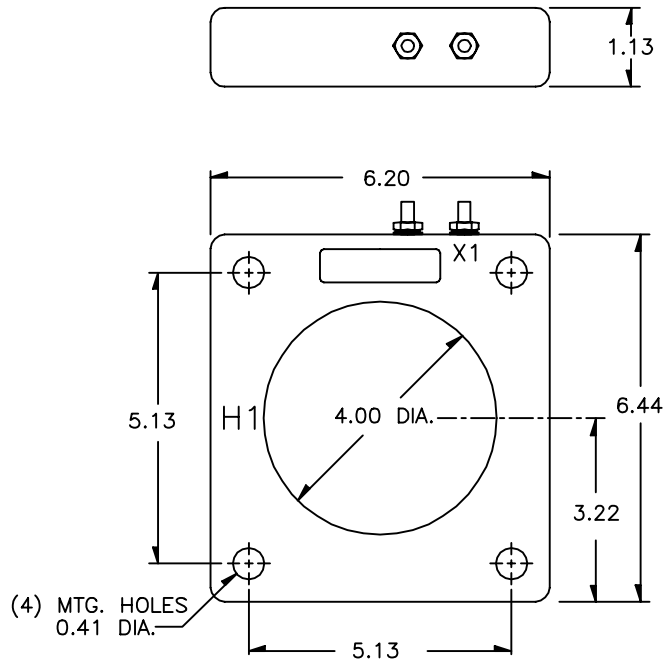
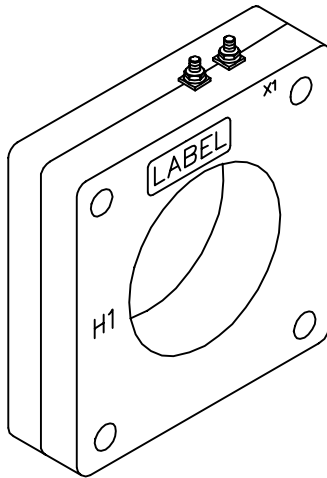

EXCITATION CURVE

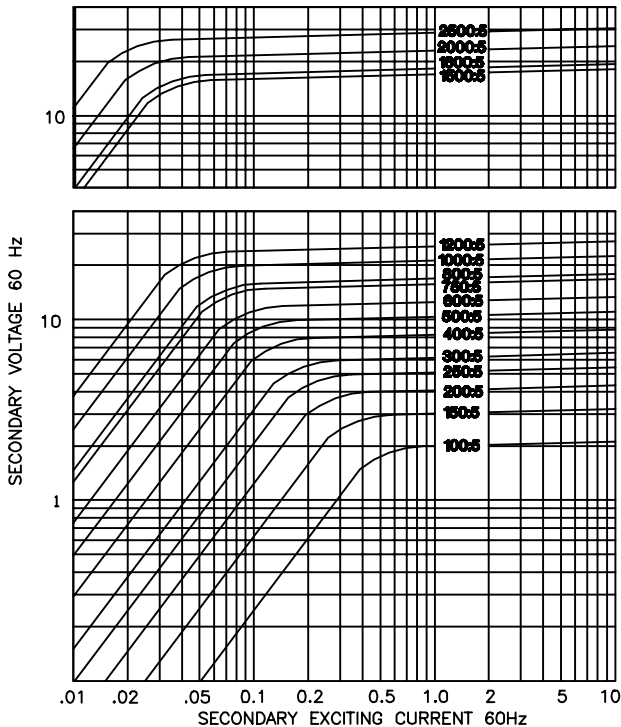

CATALOG NUMBER	CURRENT RATIO	ANSI METERING CLASS AT 60 Hz					SECONDARY WINDING RESISTANCE (OHMS @ 75 °C)
		B0.1	B0.2	B0.5	B0.9	B1.8	
660-101	100:5	4.8	-	-	-	-	0.024
660-151	150:5	1.2	2.4	-	-	-	0.034
660-201	200:5	1.2	1.2	-	-	-	0.048
660-251	250:5	0.6	1.2	2.4	-	-	0.056
660-301	300:5	0.6	0.6	1.2	4.8	-	0.069
660-401	400:5	0.6	0.6	1.2	2.4	-	0.092
660-501	500:5	0.3	0.3	0.6	1.2	2.4	0.115
660-601	600:5	0.3	0.3	0.6	1.2	2.4	0.138
660-751	750:5	0.3	0.3	0.6	1.2	2.4	0.147
660-801	800:5	0.3	0.3	0.3	0.6	1.2	0.184
660-102	1000:5	0.3	0.3	0.3	0.6	0.6	0.225
660-122	1200:5	0.3	0.3	0.3	0.3	0.6	0.270
660-152	1500:5	0.3	0.3	0.3	0.6	0.6	0.300
660-162	1600:5	0.3	0.3	0.3	0.6	0.6	0.320
660-202	2000:5	0.3	0.3	0.3	0.3	0.6	0.400
660-252	2500:5	0.3	0.3	0.3	0.3	0.3	0.500