

CURRENT TRANSFORMER

Model 311MR

Window Diameter 4.50"

APPLICATION:
Relaying.

FREQUENCY:
50-400Hz

INSULATION LEVEL:
0.6 kV, BIL 10 kV full wave.

CONTINUOUS THERMAL CURRENT RATING FACTOR:
See TRF at curves.

- Terminals are brass screws No.10-32 with one flatwasher and lockwasher.
- The transformer winding is arranged so that the turns are fully distributed between all taps.
- Order Mounting Bracket Kit No. 0221B01527 separately.
- Approximate weight 35 lbs.

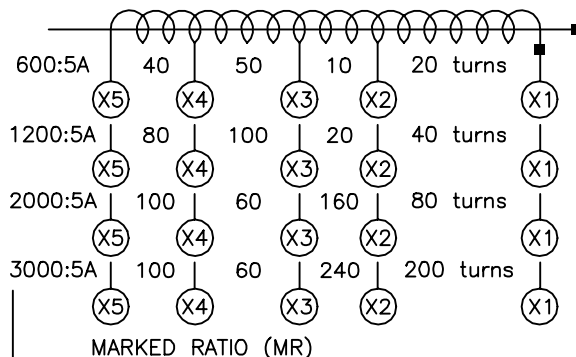
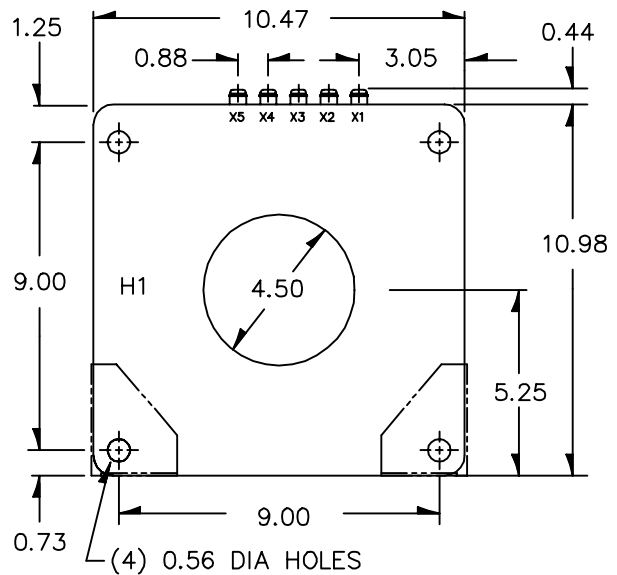
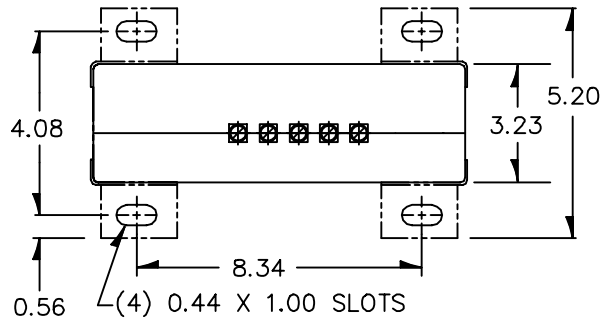
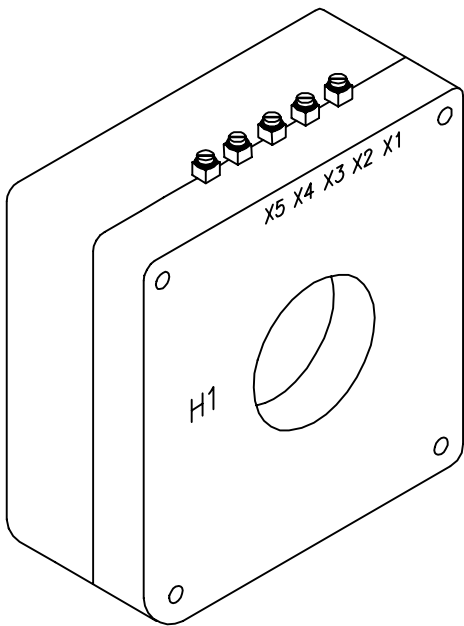

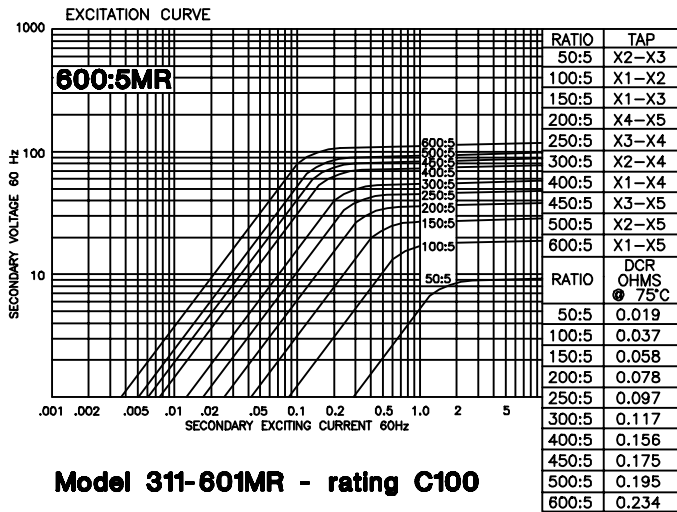

Model 311-601MR - rating C100

TRF= 2.0 @ 30°C, 1.0 @ 55°C amb.

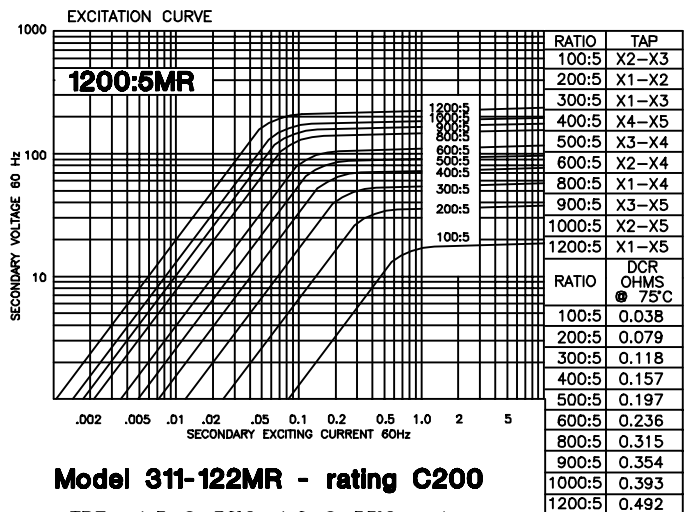

Model 311-122MR - rating C200

TRF= 1.5 @ 30°C, 1.0 @ 55°C amb.

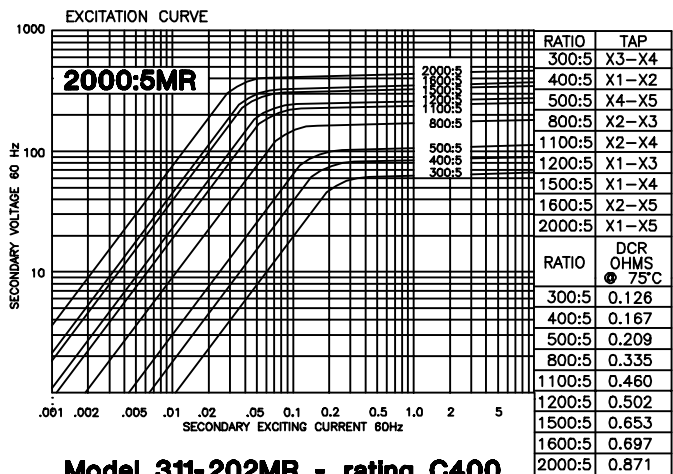

Model 311-202MR - rating C400

TRF= 1.33 @ 30°C, 1.0 @ 55°C amb.

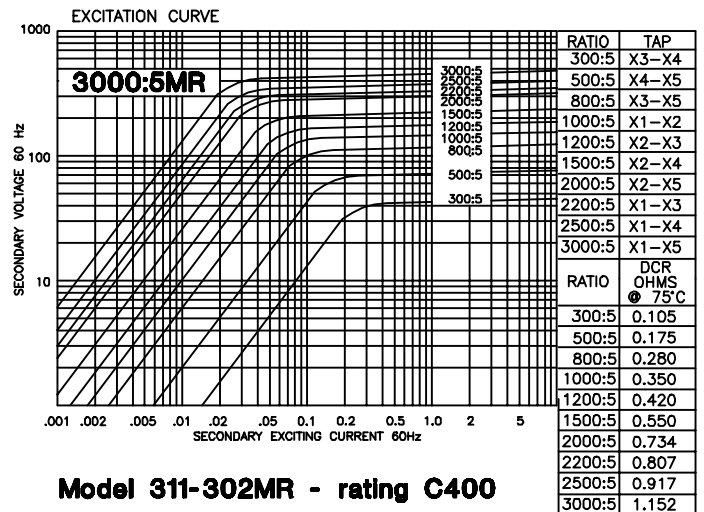

Model 311-302MR - rating C400

TRF= 1.33 @ 30°C, 1.0 @ 55°C amb.

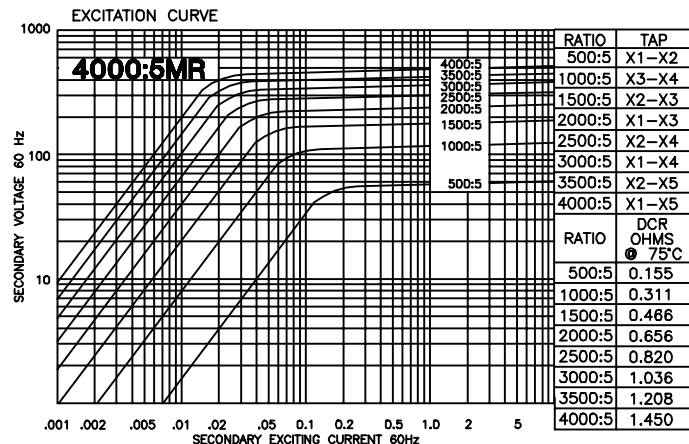

Model 311-402MR - rating C400

TRF= 1.00 @ 30°C, 0.8 @ 55°C amb.