

# CURRENT TRANSFORMER

## Model 309

Window Diameter 5.75"

**APPLICATION:**  
Relaying and metering.

**FREQUENCY:**  
50-400 Hz.

**INSULATION LEVEL:**  
600 Volts, 10 kV BIL full wave.

REGULATORY AGENCY APPROVALS

- Terminals are brass screws No. 10-32 UNF with one flatwasher and lockwasher.
- Order mounting bracket kit 0221B01525 separately.
- Multi-ratios available on request.
- Approximate weight 62 lbs.



Manufactured to meet the requirements of ANSI/IEEE C57.13.  
Classified by U.L. in accordance with IEC 44-1  
Approved for revenue metering by Industry Canada. No. AE-0661

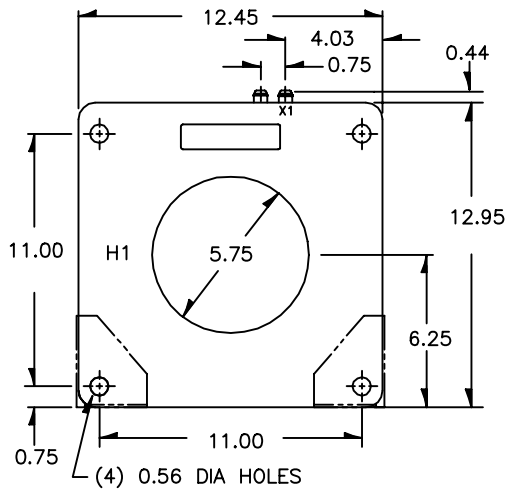
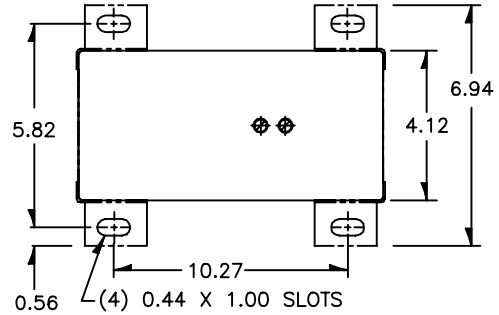
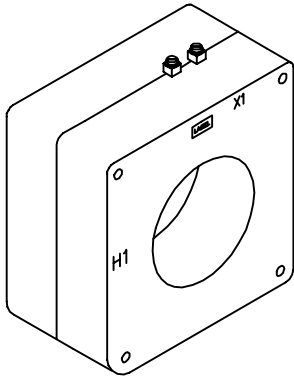

EXCITATION CURVE

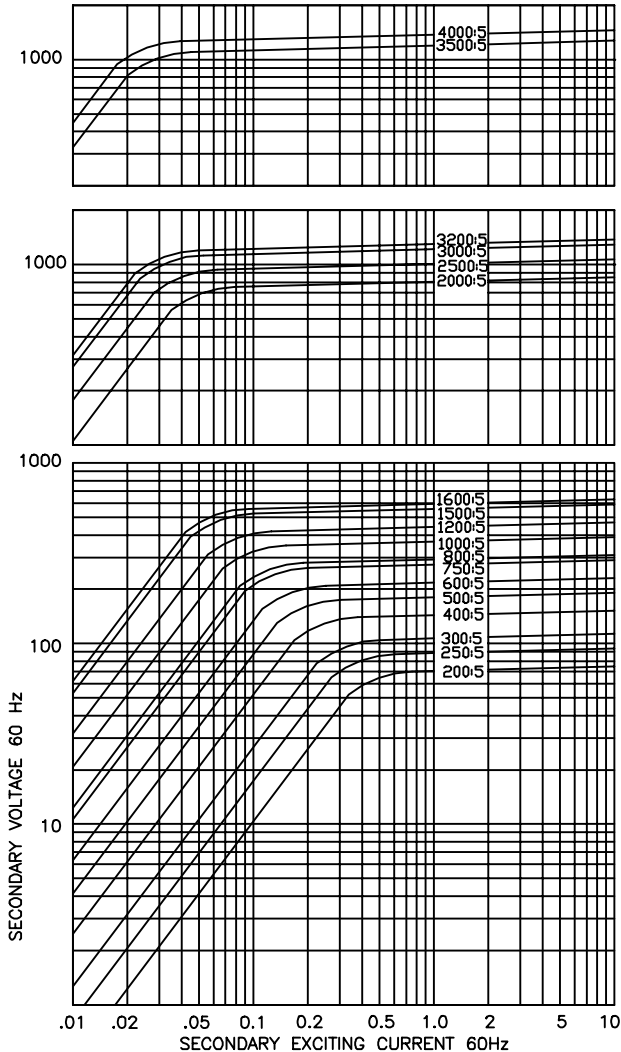

| CATALOG NUMBER | CURRENT RATIO | RELAY CLASS | ANSI METERING CLASS AT 60 Hz |      |      |      |      | SECONDARY WINDING RESISTANCE (OHMS @ 75 °C) | CONTINUOUS THERMAL RATING FACTOR |       |
|----------------|---------------|-------------|------------------------------|------|------|------|------|---|----------------------------------|-------|
|                |               |             | BO.1                         | BO.2 | BO.5 | BO.9 | B1.8 |   | @30°C                            | @55°C |
| 309-201        | 200:5         | C50         | 0.3                          | 0.6  | 1.2  | 1.2  | 2.4  | 0.141                                       | 2.0                              | 2.0   |
| 309-251        | 250:5         | C50         | 0.3                          | 0.3  | 0.6  | 1.2  | 1.2  | 0.177                                       | 2.0                              | 2.0   |
| 309-301        | 300:5         | C100        | 0.3                          | 0.3  | 0.6  | 0.6  | 1.2  | 0.212                                       | 2.0                              | 2.0   |
| 309-401        | 400:5         | C100        | 0.3                          | 0.3  | 0.3  | 0.3  | 0.6  | 0.283                                       | 2.0                              | 2.0   |
| 309-501        | 500:5         | C100        | 0.3                          | 0.3  | 0.3  | 0.3  | 0.6  | 0.354                                       | 2.0                              | 2.0   |
| 309-601        | 600:5         | C200        | 0.3                          | 0.3  | 0.3  | 0.3  | 0.3  | 0.424                                       | 2.0                              | 2.0   |
| 309-751        | 750:5         | C200        | 0.3                          | 0.3  | 0.3  | 0.3  | 0.3  | 0.530                                       | 2.0                              | 1.5   |
| 309-801        | 800:5         | C200        | 0.3                          | 0.3  | 0.3  | 0.3  | 0.3  | 0.566                                       | 2.0                              | 1.5   |
| 309-102        | 1000:5        | C200        | 0.3                          | 0.3  | 0.3  | 0.3  | 0.3  | 0.707                                       | 2.0                              | 1.5   |
| 309-122        | 1200:5        | C400        | 0.3                          | 0.3  | 0.3  | 0.3  | 0.3  | 0.849                                       | 2.0                              | 1.5   |
| 309-152        | 1500:5        | C400        | 0.3                          | 0.3  | 0.3  | 0.3  | 0.3  | 1.061                                       | 1.5                              | 1.33  |
| 309-162        | 1600:5        | C400        | 0.3                          | 0.3  | 0.3  | 0.3  | 0.3  | 1.132                                       | 1.5                              | 1.0   |
| 309-202        | 2000:5        | C400        | 0.3                          | 0.3  | 0.3  | 0.3  | 0.3  | 1.464                                       | 1.5                              | 1.0   |
| 309-252        | 2500:5        | C800        | 0.3                          | 0.3  | 0.3  | 0.3  | 0.3  | 1.830                                       | 1.33                             | 1.0   |
| 309-302        | 3000:5        | C800        | 0.3                          | 0.3  | 0.3  | 0.3  | 0.3  | 2.196                                       | 1.0                              | 0.8   |
| 309-322        | 3200:5        | C800        | 0.3                          | 0.3  | 0.3  | 0.3  | 0.3  | 2.342                                       | 1.0                              | 0.8   |
| 309-352        | 3500:5        | C800        | 0.3                          | 0.3  | 0.3  | 0.3  | 0.3  | 2.421                                       | 1.0                              | 0.8   |
| 309-402        | 4000:5        | C800        | 0.3                          | 0.3  | 0.3  | 0.3  | 0.3  | 2.766                                       | 1.0                              | 0.8   |