

CURRENT TRANSFORMER

Model 141

Window Diameter 8.13"

APPLICATION:
Relaying and metering.

FREQUENCY:
50-400 Hz.

INSULATION LEVEL:
600 Volts, 10 kV BIL full wave.

REGULATORY AGENCY APPROVALS

- Terminals are brass screws No. 10-32 UNF with one flatwasher and lockwasher.
- Order mounting bracket kit 0221B00775 separately.
- Multi-ratios available on request.
- Approximate weight 44 Lbs.



Manufactured to meet the requirements of ANSI/IEEE C57.13.
Classified by U.L. in accordance with IEC 44-1
Approved for revenue metering by Industry Canada. No. AE-0658(+)

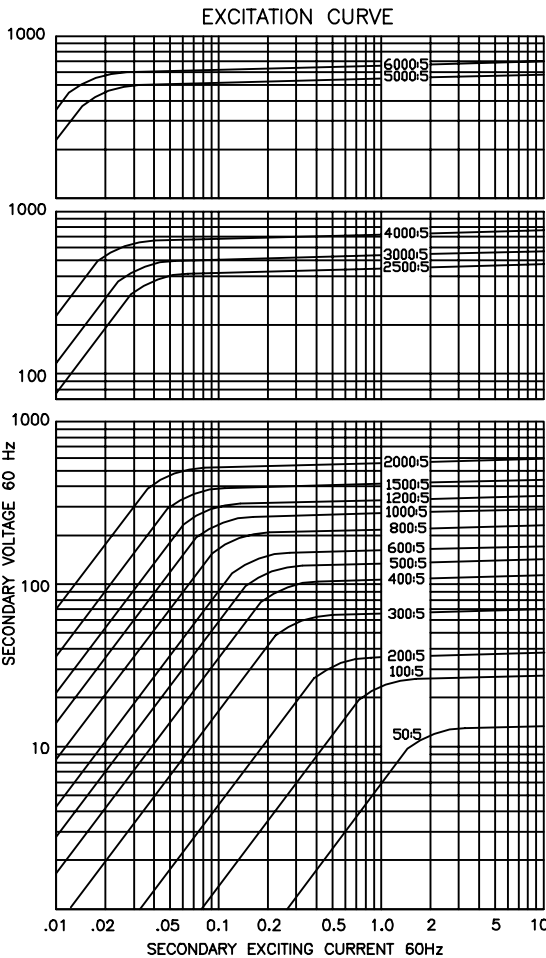
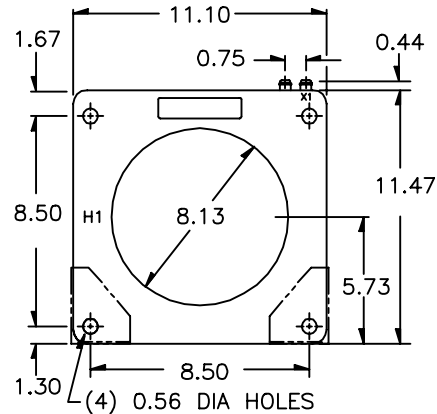
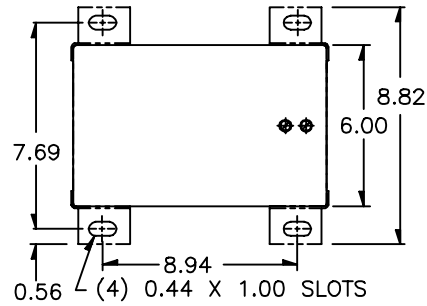
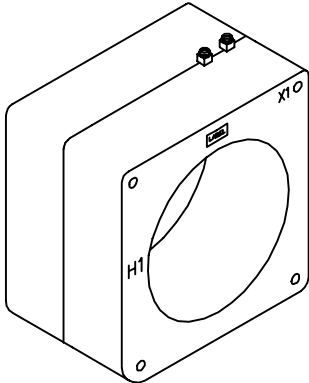

CATALOG NUMBER	CURRENT RATIO	RELAY CLASS	ANSI METERING CLASS AT 60 Hz					SECONDARY WINDING RESISTANCE (OHMS @ 75 °C)	CONTINUOUS THERMAL RATING FACTOR	
			B0.1	B0.2	B0.5	B0.9	B1.8		@30°C	@55°C
141-500	50:5	C10	4.8	-	-	-	-	0.033	2.0	2.0
141-101	100:5	C10	2.4	2.4	-	-	-	0.066	2.0	2.0
141-201	200:5	C20	0.6	1.2	1.2	2.4	4.8	0.117	2.0	2.0
141-301	300:5	C50	0.6	0.6	1.2	1.2	2.4	0.248	2.0	2.0
141-401	400:5 *	C50	0.3	0.3	0.6	0.6	1.2	0.277	2.0	2.0
141-501	500:5 *	C100	0.3	0.3	0.3	0.6	0.6	0.415	2.0	2.0
141-601	600:5 *	C100	0.3	0.3	0.3	0.3	0.6	0.498	2.0	1.5
141-801	800:5 *	C100	0.3	0.3	0.3	0.3	0.3	0.664	2.0	1.5
141-102	1000:5 *	C200	0.3	0.3	0.3	0.3	0.3	0.829	2.0	1.5
141-122	1200:5 *	C200	0.3	0.3	0.3	0.3	0.3	1.002	2.0	1.5
141-152	1500:5 *	C400	0.3	0.3	0.3	0.3	0.3	1.253	2.0	1.5
141-202	2000:5 *	C400	0.3	0.3	0.3	0.3	0.3	1.659	1.33	1.0
141-252	2500:5 *	C400	0.3	0.3	0.3	0.3	0.3	1.963	1.5	1.33
141-302	3000:5 *	C400	0.3	0.3	0.3	0.3	0.3	2.356	1.5	1.0
141-402	4000:5 *	C400	0.3	0.3	0.3	0.3	0.3	3.141	1.0	0.8
141-502	5000:5 *	C200	0.3	0.3	0.3	0.3	0.3	2.862	1.0	0.8
141-602	6000:5 *	C400	0.3	0.3	0.3	0.3	0.3	4.302	1.0	0.6