

CURRENT TRANSFORMER

Model 10

Window Diameter 1.56"

APPLICATION:
Metering.

FREQUENCY:
50-400 Hz.

INSULATION LEVEL:
600 Volts, 10 kV BIL full wave.

- Terminals are brass studs No. 8-32 UNC with one flatwasher, lockwasher and regular nut.
- Approximate weight 2.5 lbs.

REGULATORY AGENCY APPROVALS



Manufactured to meet the requirements of ANSI/IEEE C57.13.
Classified by U.L. in accordance with IEC 44-1

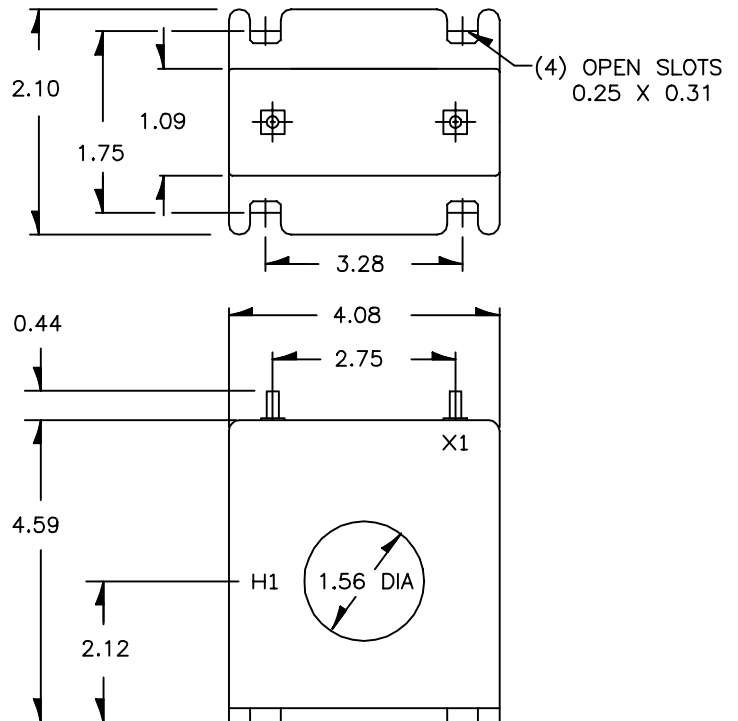
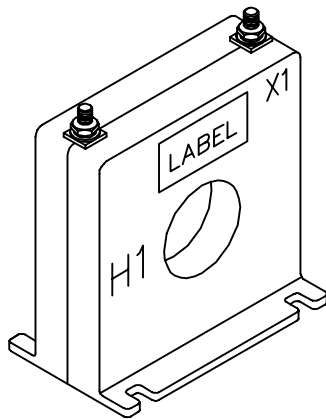

EXCITATION CURVE

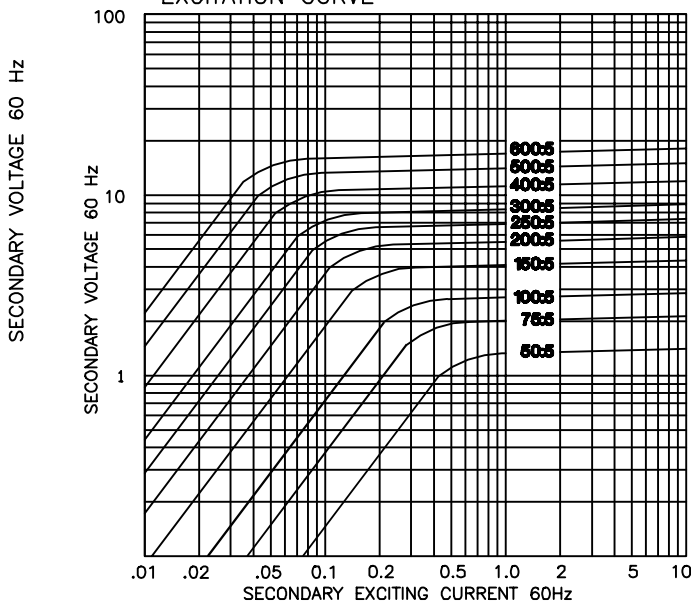

CATALOG NUMBER	CURRENT RATIO	V.A. FOR ± 1% CLASS	ANSI METERING CLASS AT 60 Hz					SECONDARY WINDING RESISTANCE (OHMS @ 75° C)	CONTINUOUS THERMAL RATING FACTOR	
			B0.1	B0.2	B0.5	B0.9	B1.8		@ 30°C	@ 55°C
10SFT-500	50:5	2.0 ± 2%	4.8	-	-	-	-	0.007	2.0	2.0
10SFT-750	75:5	2.5	1.2	4.8	-	-	-	0.010	2.0	2.0
10SFT-101	100:5	3.0	1.2	2.4	4.8	-	-	0.018	2.0	2.0
10SFT-151	150:5	5.0	0.6	0.6	2.4	4.8	-	0.031	2.0	2.0
10SFT-201	200:5	7.5	0.3	0.6	1.2	2.4	4.8	0.043	2.0	1.5
10SFT-251	250:5	10.0	0.3	0.3	1.2	1.2	2.4	0.053	2.0	1.5
10SFT-301	300:5	15.0	0.3	0.3	0.6	1.2	2.4	0.070	2.0	1.5
10SFT-401	400:5	20.0	0.3	0.3	0.3	0.6	1.2	0.114	1.5	1.0
10SFT-501	500:5	30.0	0.3	0.3	0.3	0.6	1.2	0.128	1.33	1.0
10SFT-601	600:5	40.0	0.3	0.3	0.3	0.6	0.6	0.192	1.33	0.8